

For information about other American International automotive accessories visit our website at:

<http://www.aius.net>

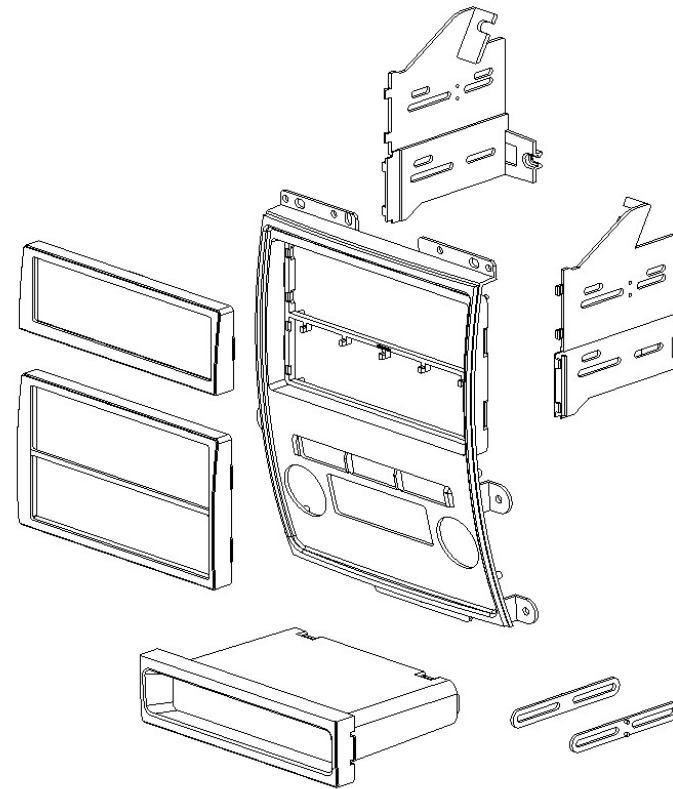

**American
International**
Car Stereo Installation Kits & Accessories



American International

2500 East Francis Street Ontario, CA 91761, U.S.A.
USA Sales (800) 336-6500
Canada Sales (888) 922-3006

VEHICLE APPLICATIONS

Nissan
2009-11 FRONTIER
2009-11 XTERRA
Suzuki
2009-11 EQUATOR

NDK739 Mounting Kit

CUSTOMER HELP LINE
USA 800-323-4329 • Canada 800-245-8777

iNDK739

KIT ASSEMBLY INSTRUCTIONS

Single ISO Mount Applications Cont.

NOTE: #1 - ISO trim ring (ITR-739) may be used in place of after-market radio's removable trim ring.
#2 - Spacers must read upright (This side up for single ISO install).

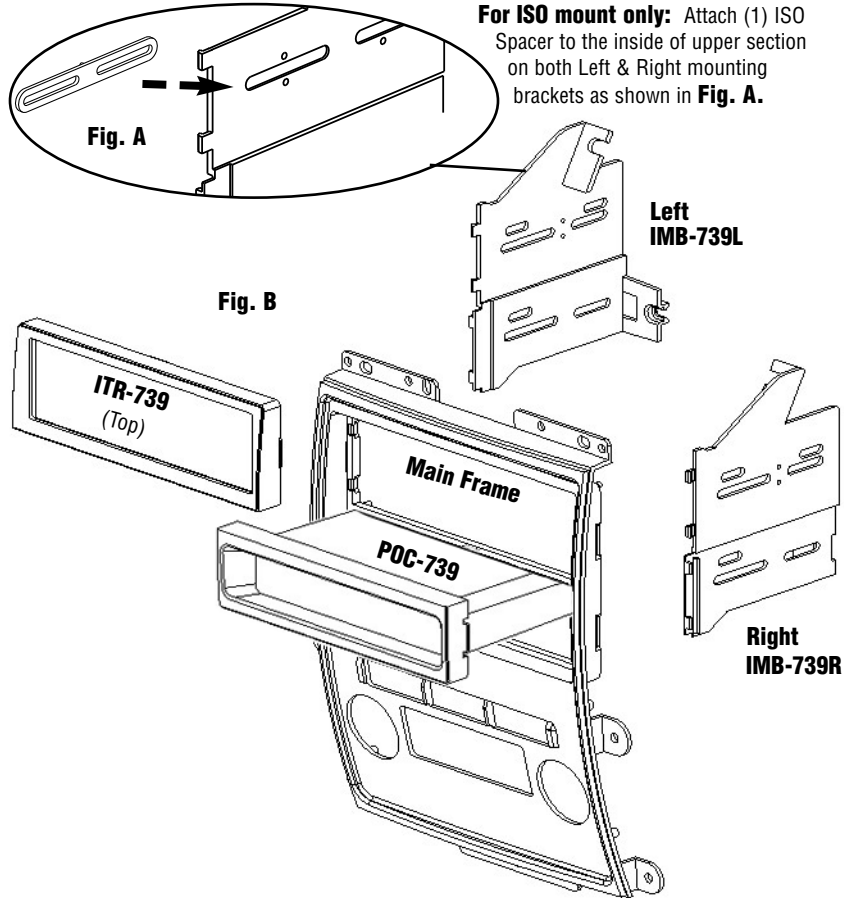

KIT ASSEMBLY INSTRUCTIONS

Double DIN & Double ISO Mount Applications

1. Attach the left and right side brackets to the main frame. (See figure below)
2. For double DIN radio applications ONLY cut and remove center rib from DITR-739 and file edges smooth.
3. Follow steps 4-6 from single ISO instructions on page 2.
4. Attach a rear support bracket to the rear of the radio components and adjust as needed to allow rear support bracket to rest in the sub-dash.

NOTE: #1 - ISO trim ring (DITR-739) must be used in place of after-market radio's trim rings. For ISO mount applications, mount after-market radio components to side brackets using screws provided with radio when possible or hardware included with kit.

