

For information about other American International automotive accessories visit our website at:

<http://www.aius.net>

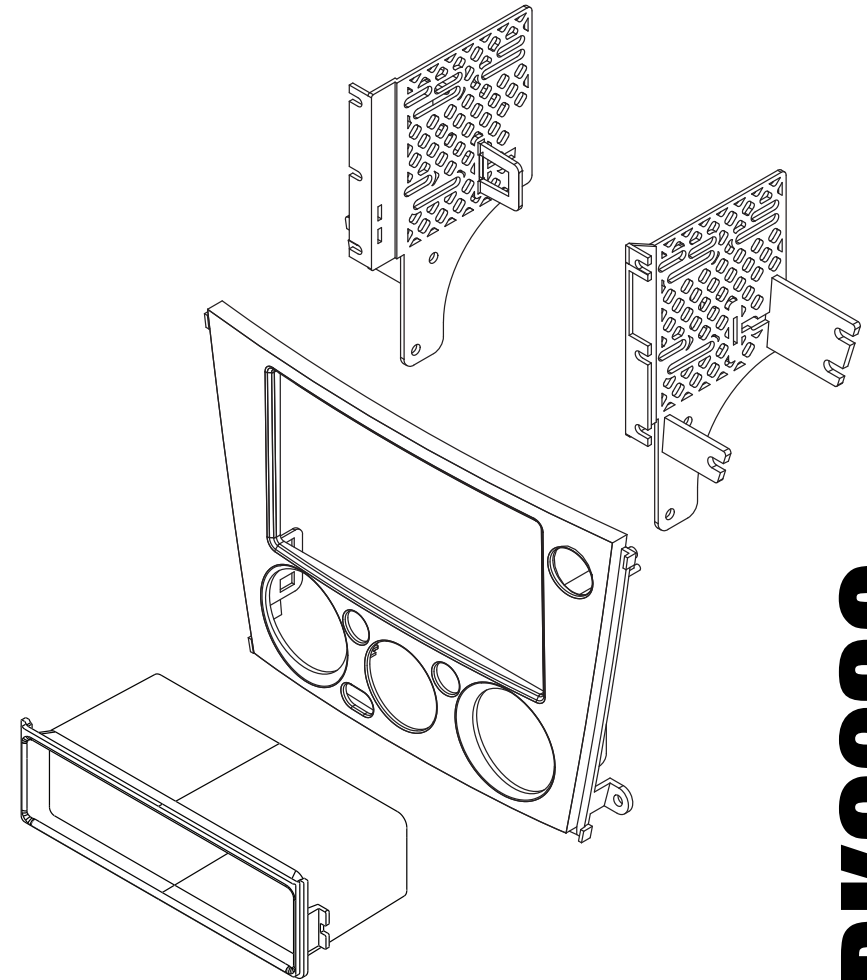

American International
Car Stereo Installation Kits & Accessories



SBK923G Mounting Kit



American International

WWW.AIUS.NET

2500 East Francis Street Ontario, CA 91761, U.S.A.

USA Sales (800) 336-6500

Canada Sales (888) 922-3006

CUSTOMER HELP LINE

USA 800-323-4329 • Canada 800-245-8777

iSBK923G

VEHICLE APPLICATIONS

Subaru

2005-09 OUTBACK (with manual climate controls)

2005-09 LEGACY (with manual climate controls)

DASH DISASSEMBLY

1. Using a soft tool Unclip panel around the shifter and remove.
2. Remove (1) Phillips screw on the bottom left and right side dash panels. Unclip and remove
3. Remove pocket from above radio and unclip the climate control cable to the right of the instrument cluster. Note: you can also reach this cable from under the steering column.
4. Remove (6) Phillips Screws from radio brackets. Remove radio, unplug harnesses.
5. Remove (4) screws securing the climate control to the radio/climate control assembly (save to be used on kit assembly) then unclip and remove climate control.
6. Remove (2) screws securing the hazard button to the OEM radio (save to be used on kit assembly).

KIT ASSEMBLY INSTRUCTIONS

Single ISO Mount Applications

1. Reinstall the OEM hazard button using the (2) Phillips screws from the dash disassembly.
2. Reinstall the OEM climate control assembly to the SBK923G mainframe
3. Insert pocket into lower section of the SBK923G brackets
4. Install brackets to rear of main frame using the (6) screws provided.
5. Using the (4) Phillips screws from the dash disassembly screw the OEM climate control assembly to the SBK923G brackets.
6. Insert ISO mountable radio between ISO mount brackets and loosely attach to sides of radio using screws provided with radio when possible, or screws supplied with kit.
7. Using the main frame of the SBK923G as a guide, slide radio forward or backward for desired look and then tighten screws to the radio.

NOTE: Attach a rear support bracket to the rear of the new radio and adjust as necessary to support the weight of the radio. Suggested.

Fig A

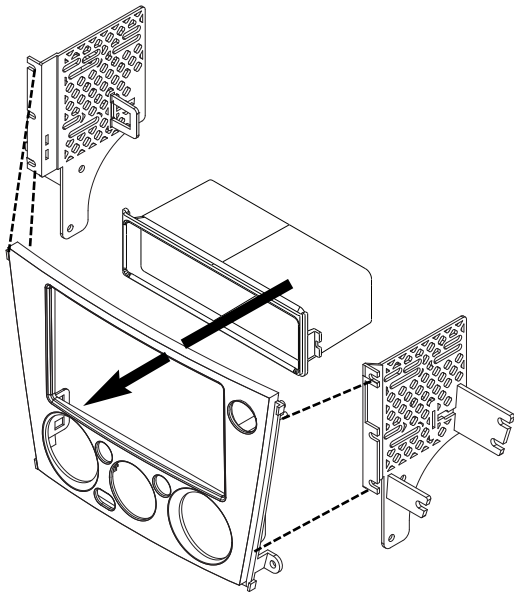

Double DIN Mount Applications

See Fig B for bracket tab removal.

1. Reinstall the OEM hazard button using the (2) Phillips screws from the dash disassembly.
2. Reinstall the OEM climate control assembly to the SBK923G mainframe
3. Install brackets to rear of main frame using the (6) screws provided.
4. Using the (4) Phillips screws from the dash disassembly screw the OEM climate control assembly to the SBK923G brackets.
5. Insert ISO mountable radio between ISO mount brackets and loosely attach to sides of radio using screws provided with radio when possible, or screws supplied with kit.
6. Using the main frame of the SBK923G as a guide, slide radio forward or backward for desired look and then tighten screws to the radio.

NOTE: Attach a rear support bracket to the rear of the new radio and adjust as necessary to support the weight of the radio. Suggested.

Fig B

