

For information about other American International automotive accessories visit our website at:

<http://www.aius.net>

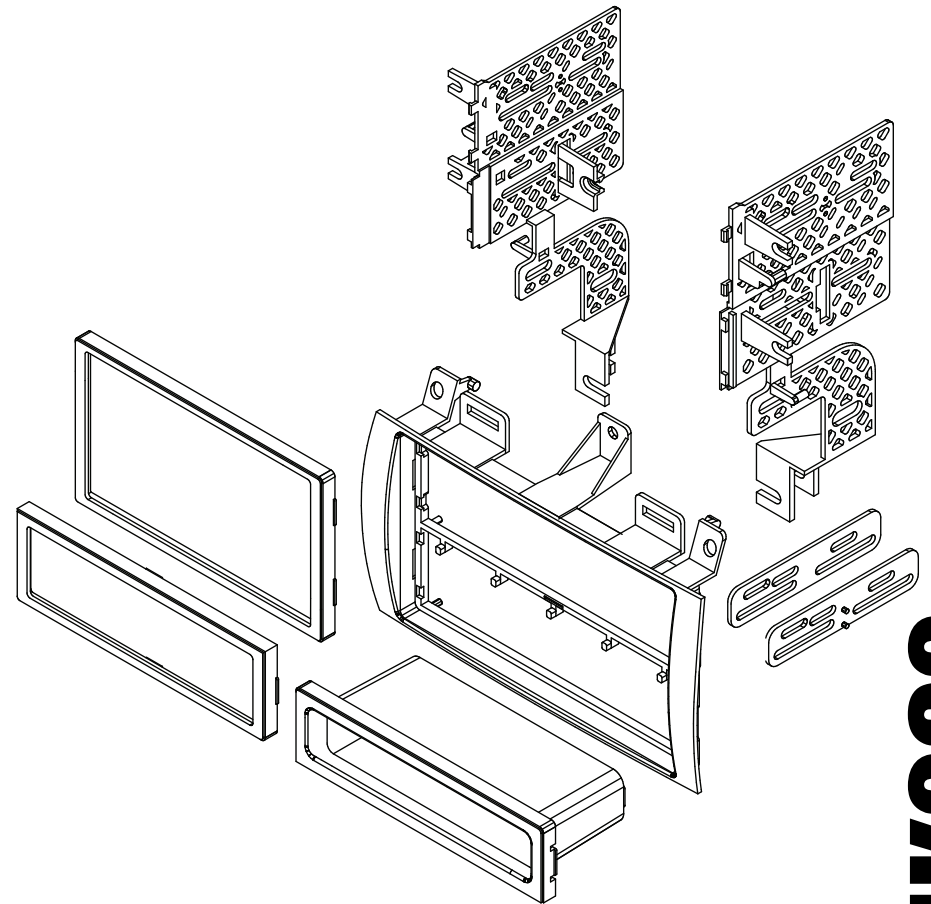

**American
International**
Car Stereo Installation Kits & Accessories



GMK262 Mounting Kit



American International

WWW.AIUS.NET

2500 East Francis Street Ontario, CA 91761, U.S.A.

USA Sales (800) 336-6500

Canada Sales (888) 922-3006

CUSTOMER HELP LINE

8am-4:30 P.S.T. Monday-Friday Except Holidays

USA 800-323-4329 • Canada 800-245-8777

iGMK262

VEHICLE APPLICATIONS

CADILLAC

1996-99 DEVILLE (Console Shift)

2000-05 DEVILLE

1996-02 ELDORADO

1996-05 SEVILLE

1996-02 CADILLAC ELDORADO
1996-97 CADILLAC SEVILLE

DASH DISASSEMBLY INSTRUCTIONS

1. Remove the C-clip from the shifter, remove shifter.
2. Remove (3) Phillips head screws from the ashtray assembly.
3. Using a soft tool pry and remove switch panel above OEM radio.
4. Remove (4) Phillips head screws from the radio, Remove.
5. Remove (6) retaining nuts from radio brackets, Remove climate controls.

1996-02 CADILLAC ELDORADO
1996-97 CADILLAC SEVILLE

KIT ASSEMBLY INSTRUCTIONS

1. From the main frame remove all mounting tabs (shaded in diagram below).
2. From both left and right brackets remove lower front mounting tabs (shaded in diagram below).

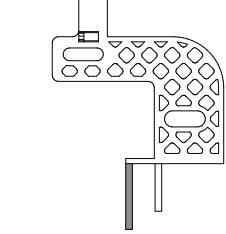
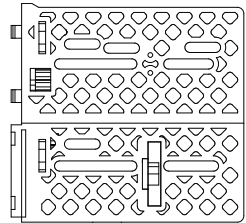
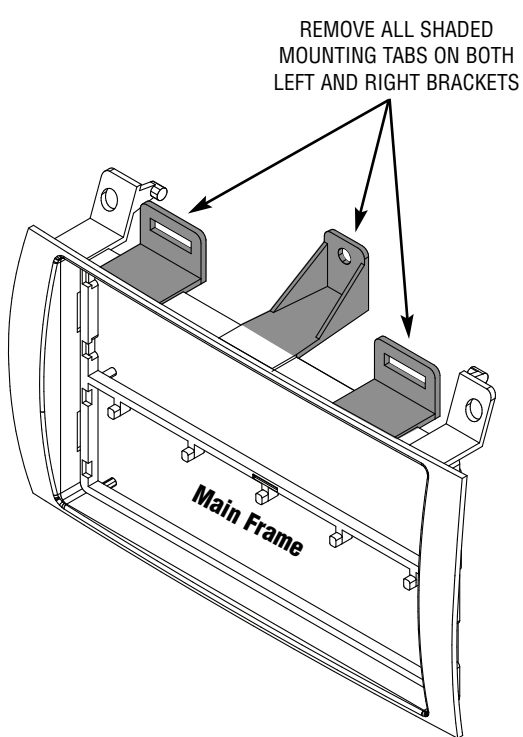

REMOVE ALL SHADED MOUNTING TABS ON BOTH LEFT AND RIGHT BRACKETS

NOTES

NOTES

Single DIN Mount Applications

1. Attach the left and right side brackets to the main frame.
2. Insert pocket (part # UNI-POC) into LOWER section of the main frame.
3. Attach left and right side brackets to the rear of the pocket using screws supplied.
4. Insert DIN sleeve from your new radio into the UPPER section of the installation kit.
5. Depress the tabs from inside the sleeves opening upward, outward, and downward to secure sleeve to the installation kit.
6. Install radio into sleeve and lock into place.
7. Install the OEM climate control assembly onto the GMK262 brackets/panel using the 2 OEM retaining nuts.
8. SUGGESTED...Attach a rear support bracket to the rear of the new radio and adjust as necessary to attach to the rear support stud locate on the back of the pocket using the small Phillips screw supplied with kit.

Note: ISO trim ring (UNI-T1) may be used in place of after-market radio's removable trim ring.

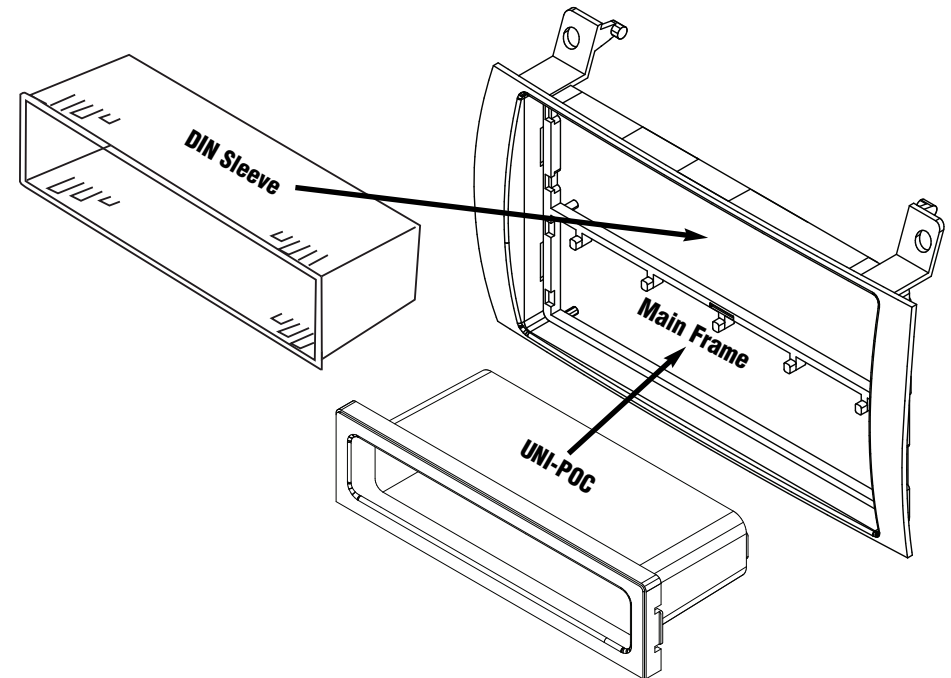

Single ISO Mount Applications

1. Attach the left and right side brackets to the main bracket.
2. Insert pocket (part # UNI-POC) into LOWER section of the main frame.
3. Attach left and right side brackets to the rear of the pocket using screws supplied.
4. Attach (1) ISO Spacer to the inside of UPPER section on both Left & Right mounting brackets (See figure A).
5. Insert ISO mountable radio between ISO mount brackets. Then loosely attach to sides of radio using screws provided with radio or hardware included with kit.
6. Slide radio component forward or backward for desired look and tighten screws.
7. Install the OEM climate control assembly onto the GMK262 brackets/panel using the 2 OEM retaining nuts.
8. SUGGESTED... Attach a rear support bracket to the rear of the new radio and adjust as necessary to attach to the rear support stud locate on the back of the pocket using the small Phillips screw supplied with kit.

Note: ISO trim ring (UNI-T1) may be used in place of after-market radio's removable trim ring.

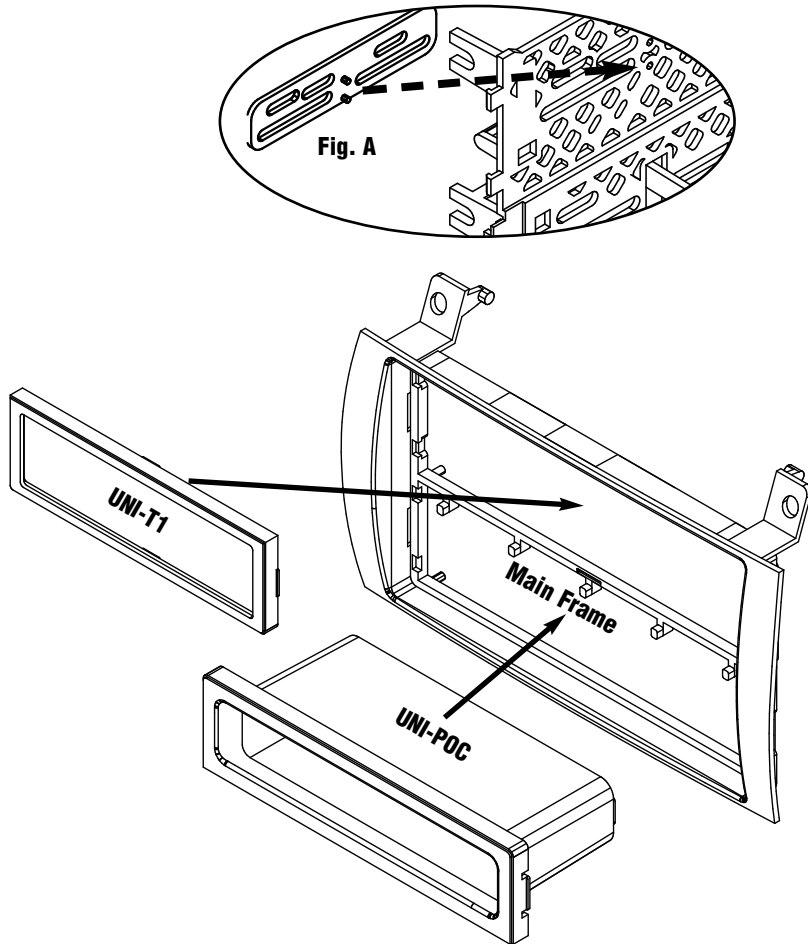

Double DIN Mount Applications

Note: REMOVE POCKET SUPPORT TABS (Both L&R mounting brackets).

1. Cut and remove the center rib from the main frame and file edges smooth.
2. Attach the left and right side brackets to the main frame.
3. Insert radio between ISO mount brackets. Then loosely attach to sides of radio using screws provided with radio or hardware included with kit.
4. Slide radio component forward or backward for desired look and tighten screws.
5. SUGGESTED... Attach a rear support bracket to the rear of the radio components and adjust as needed to allow rear support bracket to rest/mount in the sub-dash.

Note: DBL ISO trim ring (UNI-T2) may be used in place of after-market radio's removable trim ring.

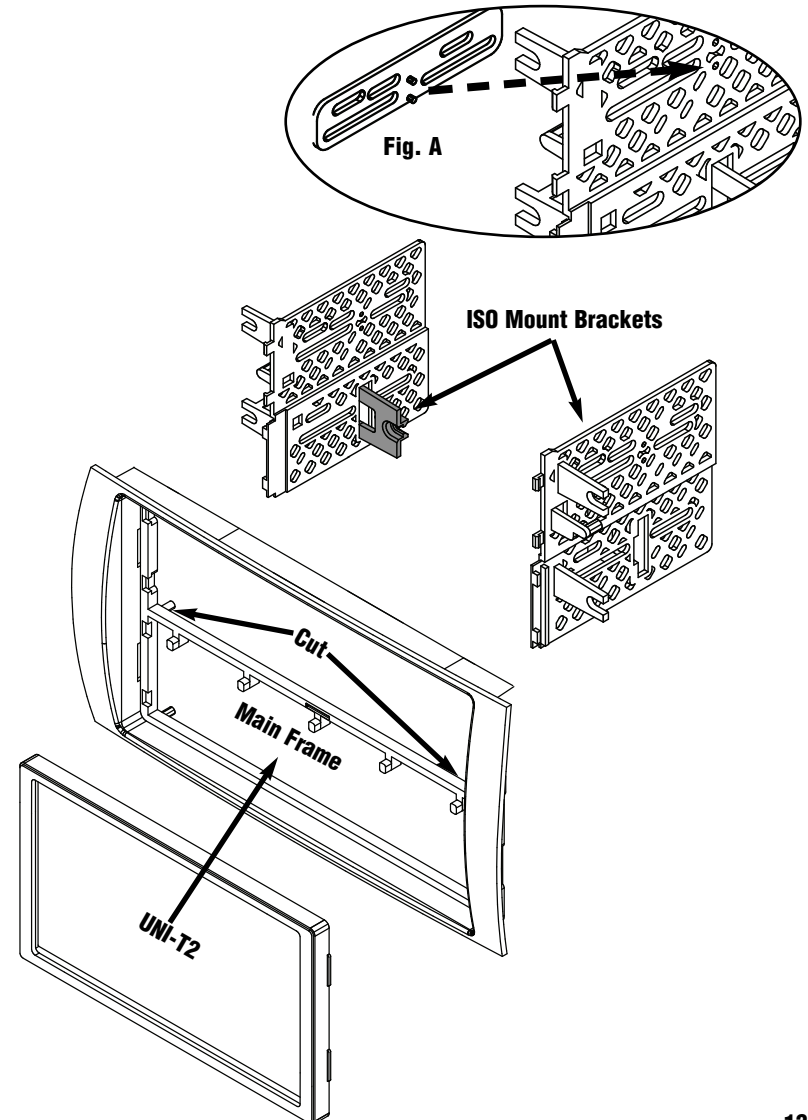

Single ISO Mount Applications

1. Attach the left and right side brackets to the main bracket.
2. Insert pocket (part # UNI-POC) into LOWER section of the main frame.
3. Attach left and right side brackets to the rear of the pocket using screws supplied.
4. Attach (1) ISO Spacer to the inside of UPPER section on both Left & Right mounting brackets
5. Insert ISO mountable radio between ISO mount brackets. Then loosely attach to sides of radio using screws provided with radio or hardware included with kit.
6. Slide radio component forward or backward for desired look and tighten screws.
7. SUGGESTED... Attach a rear support bracket to the rear of the new radio and adjust as necessary to attach to the rear support stud locate on the back of the pocket using the small Phillips screw supplied with kit.

Note: ISO trim ring (UNI-T1) may be used in place of after-market radio's removable trim ring.

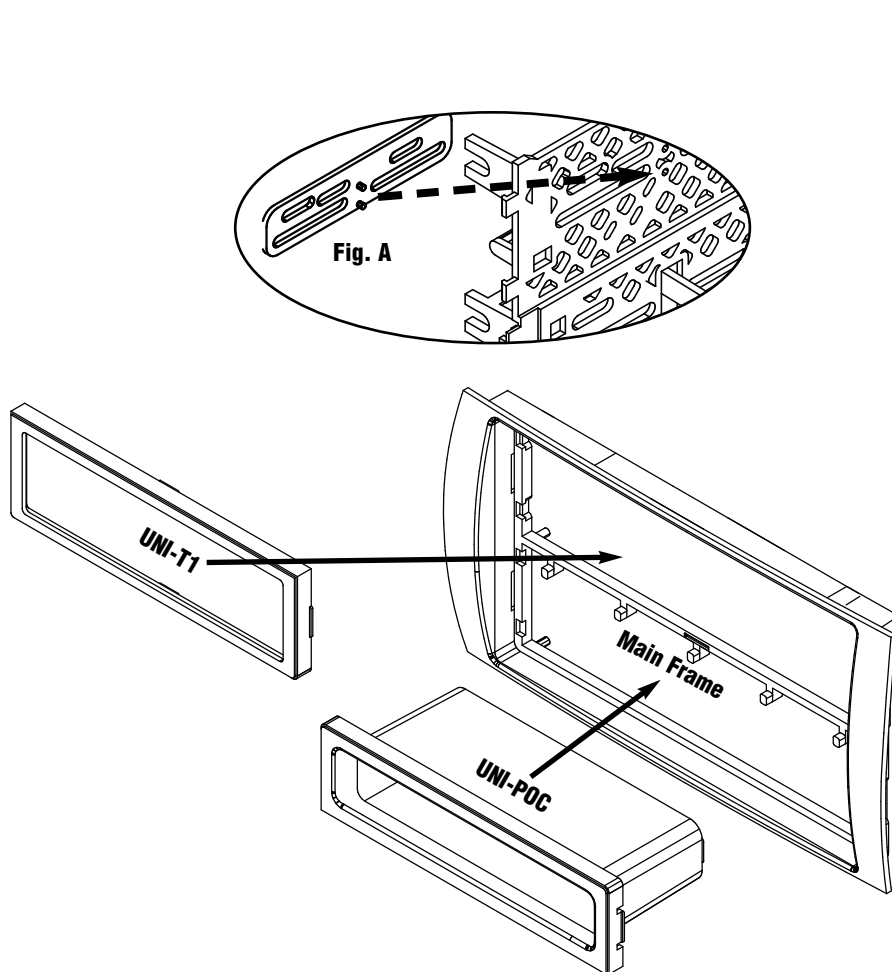

Double DIN Mount Applications

1. REMOVE POCKET SUPPORT TABS (Both L&R mounting brackets).
2. Cut and remove the center rib from the main frame and file edges smooth.
3. Attach the left and right side brackets to the main frame.
4. Attach (1) ISO Spacer to the inside of UPPER section on both Left & Right (See Figure A).
5. Slide radio component forward or backward for desired look and tighten screws.
6. Install the OEM climate control assembly onto the GMK262 brackets/panel using the 2 OEM retaining nuts.
7. SUGGESTED... Attach a rear support bracket to the rear of the radio components and adjust as needed to allow rear support bracket to rest/mount in the sub-dash.

Note: DBL ISO trim ring (UNI-T2) may be used in place of after-market radio's removable trim ring.

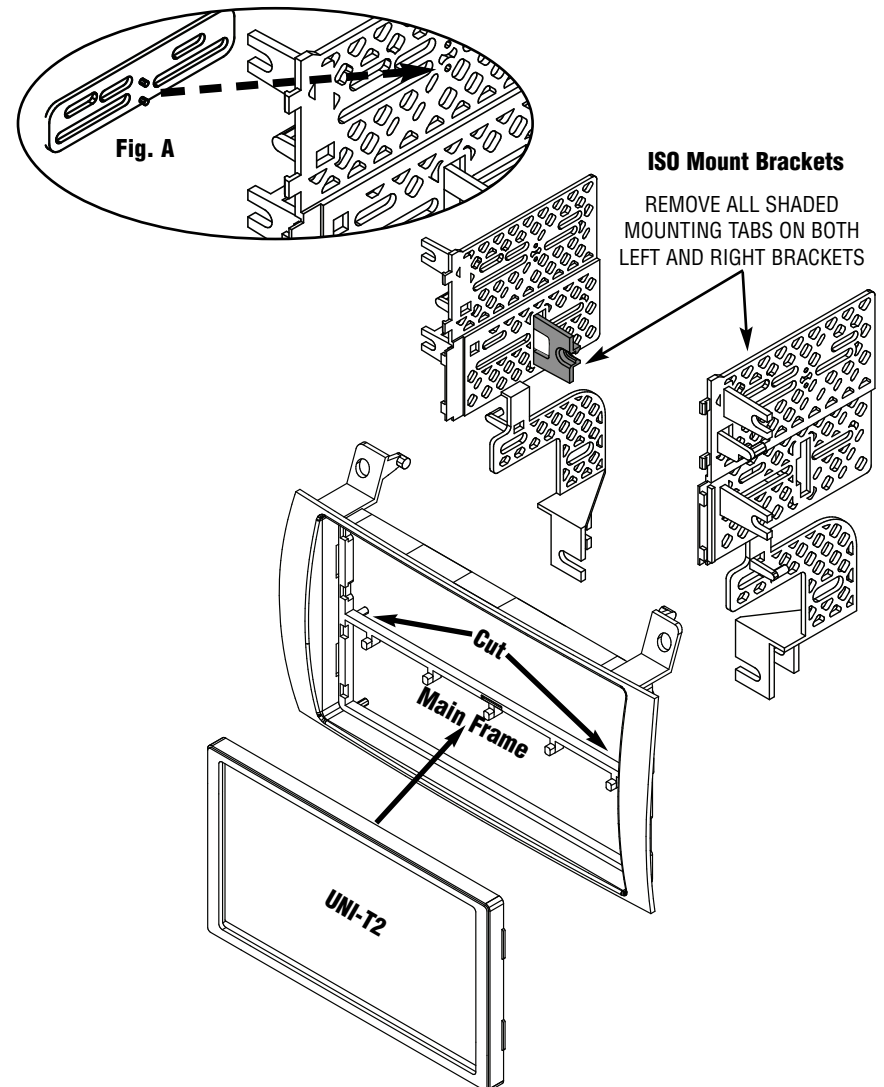

1996-99 CADILLAC DEVILLE (Console Shift)
1998-05 CADILLAC SEVILLE

DASH DISASSEMBLY INSTRUCTIONS

1. Remove (3) Phillips head screws from the ashtray assembly.
2. Using a soft tool pry and remove switch panel above OEM radio.
3. Remove (4) Phillips head screws from the radio, Remove.
4. Remove (6) retaining nuts from radio brackets, Remove climate controls.

1996-02 CADILLAC DEVILLE (Console Shift)
1998-05 CADILLAC SEVILLE

KIT ASSEMBLY INSTRUCTIONS

1. From the main frame remove all mounting tabs shaded in diagram below.
2. From both left and right brackets remove lower rear mounting tabs (shaded in diagram below).

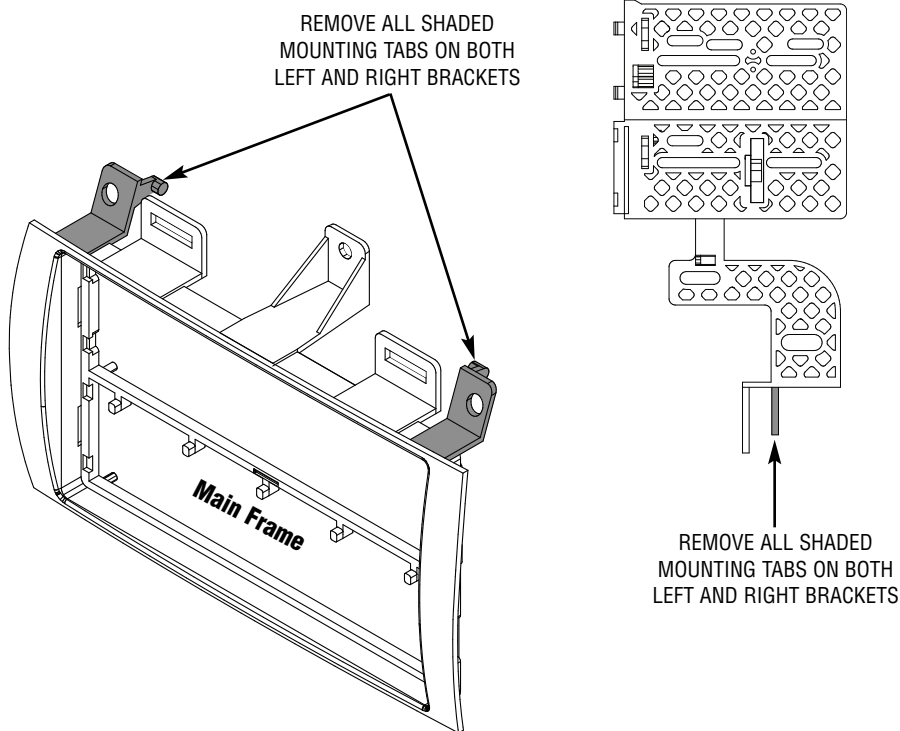

Single DIN Mount Applications

1. Attach the left and right side brackets to the main frame.
2. Insert pocket (part # UNI-POC) into LOWER section of the main frame.
3. Attach left and right side brackets to the rear of the pocket using screws supplied.
4. Insert DIN sleeve from your new radio into the UPPER section of the installation kit.
5. Depress the tabs from inside the sleeves opening upward, outward, and downward to secure sleeve to the installation kit.
6. Install radio into sleeve and lock into place.
7. SUGGESTED...Attach a rear support bracket to the rear of the new radio and adjust as necessary to attach to the rear support stud locate on the back of the pocket using the small Phillips screw supplied with kit.

Note: ISO trim ring (UNI-T1) may be used in place of after-market radio's removable trim ring

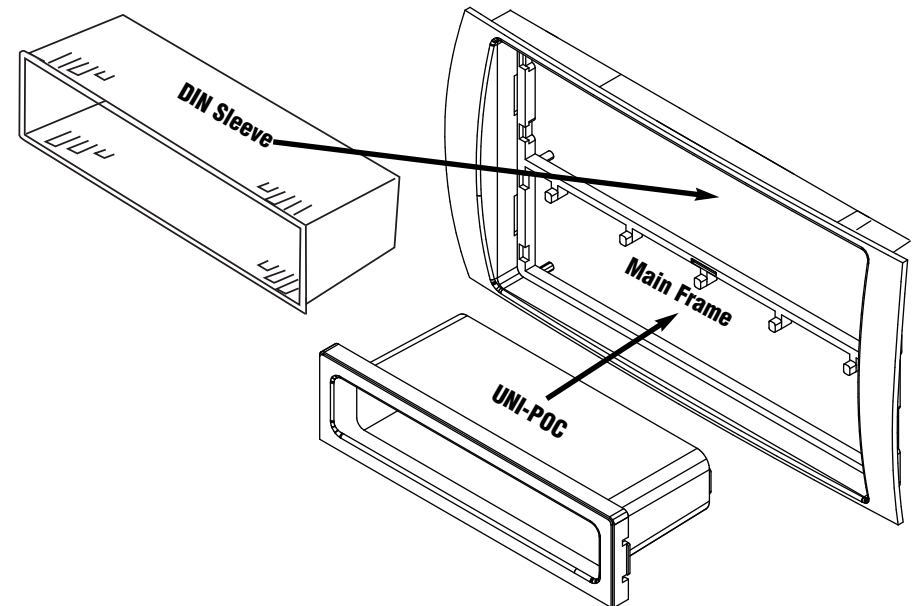

DASH DISASSEMBLY INSTRUCTIONS

1. Using a soft tool pry and remove panel around OEM radio and climate controls.
2. Remove OEM radio by depressing clips on both sides.

KIT ASSEMBLY INSTRUCTIONS

1. Remove all mounting tabs from the main frame (shaded in diagram below).
2. Remove lower section on both left and right brackets (shaded in diagram below).

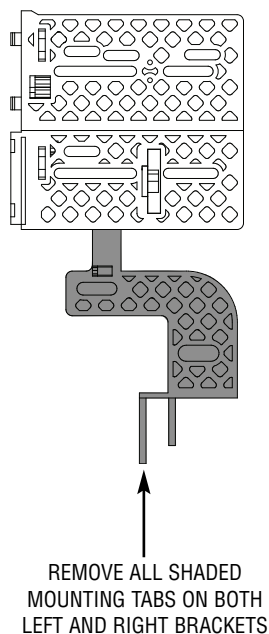
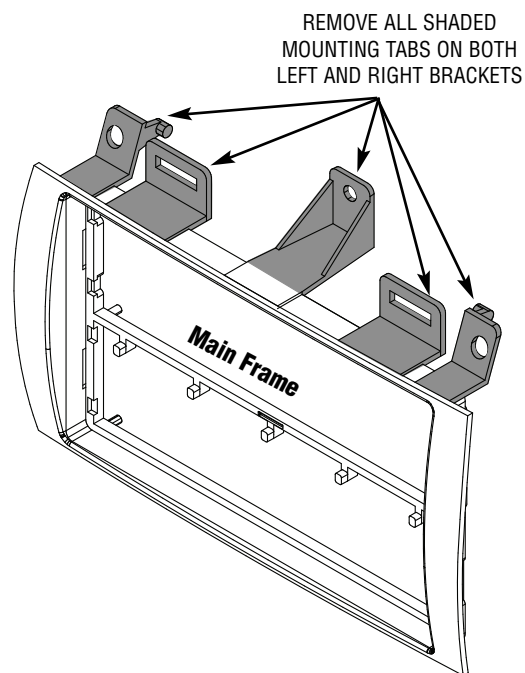

Single DIN Mount Applications

1. Attach the left and right side brackets to the main frame.
2. Insert pocket (part # UNI-POC) into LOWER section of the main frame.
3. Attach left and right side brackets to the rear of the pocket using screws supplied.
4. Insert DIN sleeve from your new radio into the UPPER section of the installation kit.
5. Depress the tabs from inside the sleeves opening upward, outward, and downward to secure sleeve to the installation kit.
6. Install radio into sleeve and lock into place.
7. Install the OEM climate control assembly onto the GMK262 brackets/panel using the 2 OEM retaining nuts.
8. SUGGESTED...Attach a rear support bracket to the rear of the new radio and adjust as necessary to attach to the rear support stud locate on the back of the pocket using the small Phillips screw supplied with kit.

Note: ISO trim ring (UNI-T1) may be used in place of after-market radio's removable trim ring.

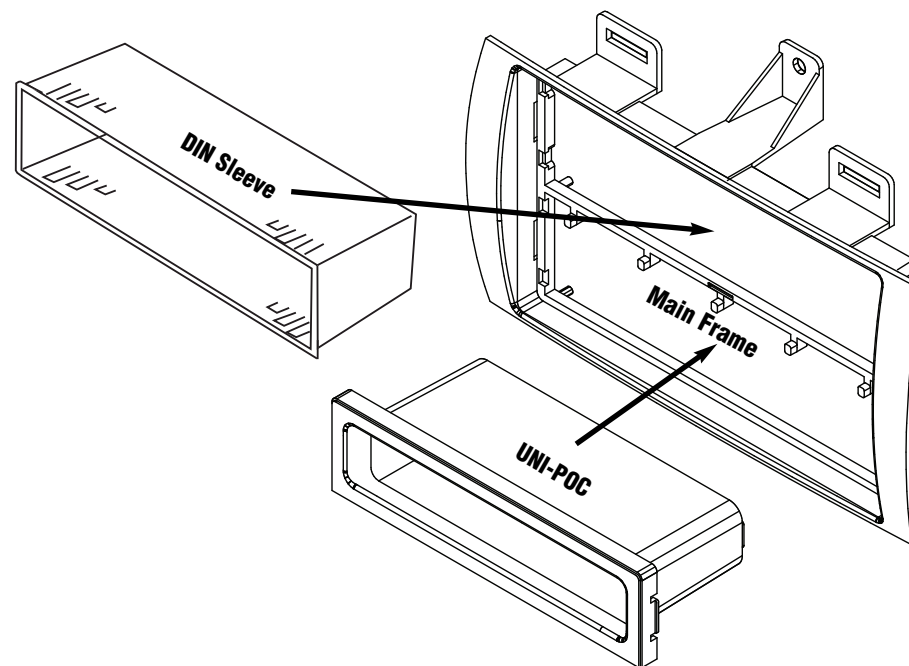

Single ISO Mount Applications

1. Attach the left and right side brackets to the main bracket.
2. Insert pocket (part # UNI-POC) into LOWER section of the main frame.
3. Attach left and right side brackets to the rear of the pocket using screws supplied.
4. Attach (1) ISO Spacer to the inside of UPPER section on both Left & Right mounting brackets (See figure A below).
5. Insert ISO mountable radio between ISO mount brackets. Then loosely attach to sides of radio using screws provided with radio or hardware included with kit.
6. Slide radio component forward or backward for desired look and tighten screws.
7. Install the OEM climate control assembly onto the GMK262 brackets/panel using the 2 OEM retaining nuts.
8. SUGGESTED... Attach a rear support bracket to the rear of the new radio and adjust as necessary to attach to the rear support stud locate on the back of the pocket using the small Phillips screw supplied with kit.

Note: ISO trim ring (UNI-T1) may be used in place of after-market radio's removable trim ring.

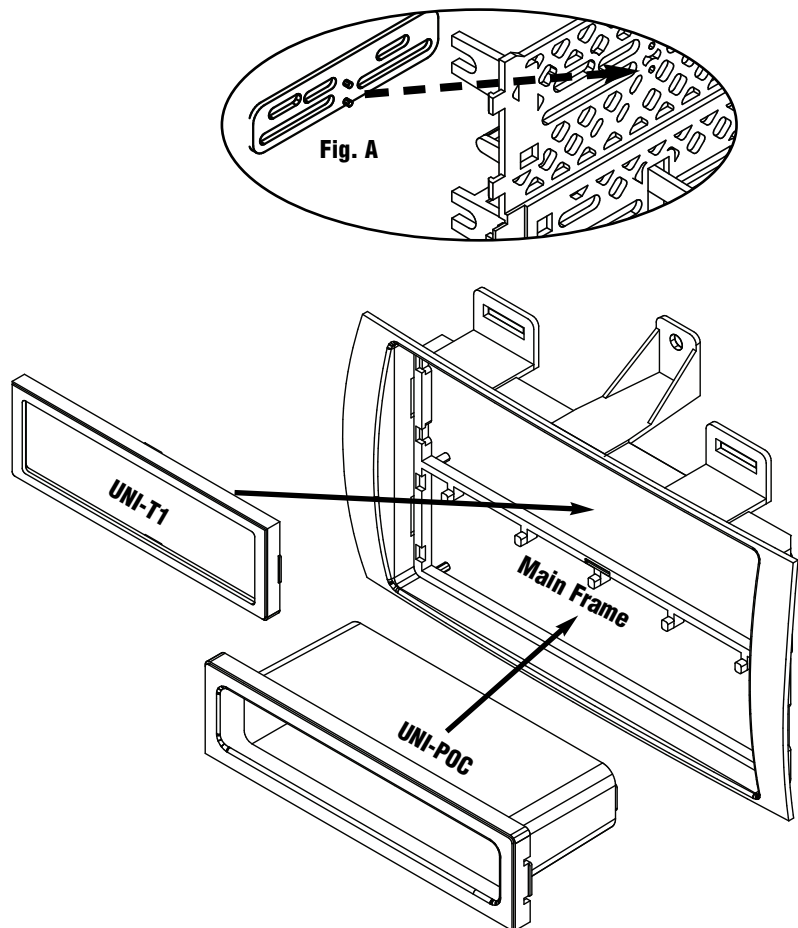

Double DIN Mount Applications

Note: REMOVE POCKET SUPPORT TABS (Both L&R mounting brackets).

1. Cut and remove the center rib from the main frame and file edges smooth.
2. Attach the left and right side brackets to the main frame.
3. Attach (1) ISO Spacer to the inside of UPPER section on both Left & Right (See Figure A below).
4. Slide radio component forward or backward for desired look and tighten screws.
5. Install the OEM climate control assembly onto the GMK262 brackets/panel using the 2 OEM retaining nuts.
6. SUGGESTED... Attach a rear support bracket to the rear of the radio components and adjust as needed to allow rear support bracket to rest/mount in the sub-dash.

Note: DBL ISO trim ring (UNI-T2) may be used in place of after-market radio's removable trim ring.

