

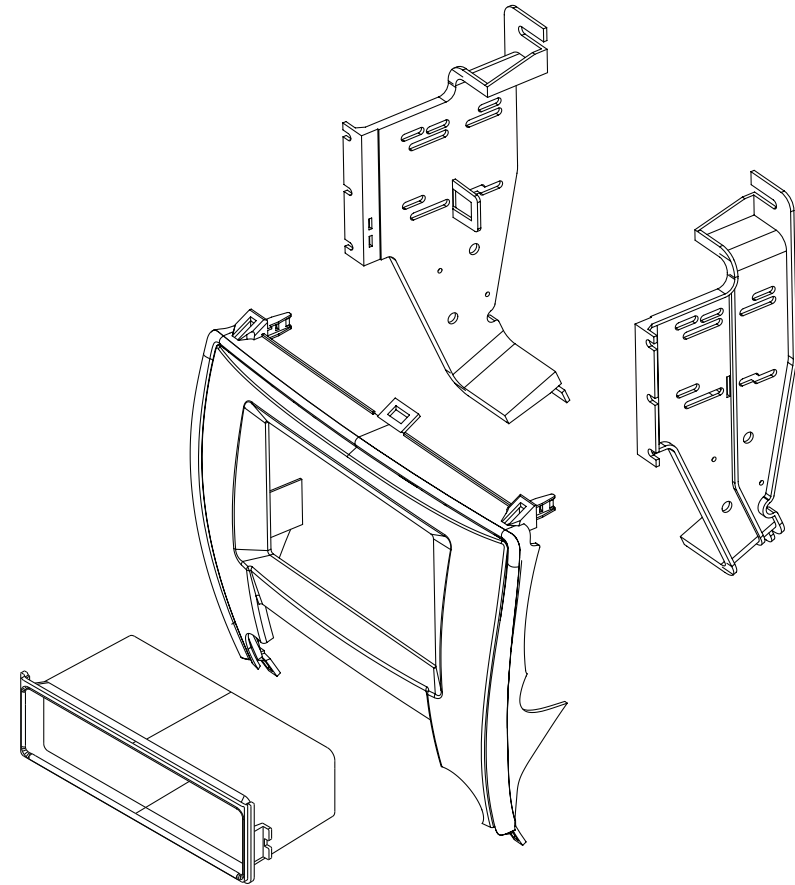

**American
International**
Car Stereo Installation Kits & Accessories



TOYK978 Mounting Kit



www.aampglobal.com www.aius.net
2500 East Francis Street Ontario, CA 91761, U.S.A.
Sales: (800) 477-2267
Intl: (727) 572-9255
Support: 888-228-5560

VEHICLE APPLICATION

Toyota
2015-17 CAMRY

DASH DISASSEMBLY

1. Using a soft tool unsnap and remove the tray behind the shifter/cup holder panel.
2. Remove (2) Phillips screws from shifter/cup holder panel. Unsnap exposing the (2) Phillips screws for the pocket/door assembly. (You may need to put the car in Neutral, making sure the emergency brake is on)
3. Remove (2) Phillips screws from the pocket/door assembly, unplug, unplug and remove.
4. Remove (2) Phillips screws and (4) 10mm bolts from the radio/climate controls, unplug, unplug and remove.
5. Remove (4) Phillips screws from climate control brackets and (6) Phillips screws from the radio, remove brackets.
6. Unsnap the climate controls from the radio.
7. Remove (4) snap clips from the OEM radio panel and reinstall in the TOYK978 mainframe (Note these are tab specific TOP & Bottom)
8. Install the OEM climate control to the TOYK978 mainframe.

KIT ASSEMBLY INSTRUCTIONS

Single ISO Mounting Applications

1. Insert ISO mountable radio between ISO mount brackets and loosely attach to sides of radio using screws provided with radio when possible, or screws supplied with kit.
2. Using the (4) Phillips screws removed from the OEM brackets, install the brackets with radio onto the OEM climate controls. (NOTE: Align with locator tabs on TOYK978 brackets)
3. Install brackets to rear of main using the (6) screws provided.
4. Using the main frame of the TOYK978 as a guide, slide radio forward or backward for desired look and then tighten screws to the radio.
5. Insert pocket into lower section of the TOYK978 brackets.

Note: Attach a rear support bracket to the rear of the new radio and adjust as necessary to support the weight of the radio. Suggested.

Fig. A

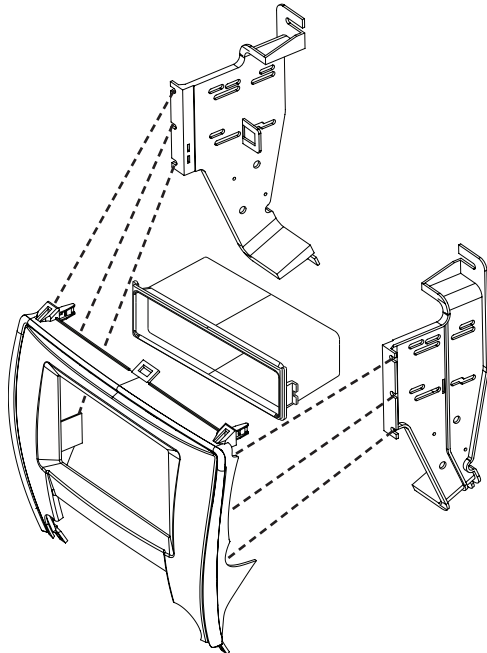

Double DIN Mounting Applications

See Fig B for bracket tab removal.

1. Insert ISO mountable radio between ISO mount brackets and loosely attach to sides of radio using screws provided with radio when possible, or screws supplied with kit.
2. Using the (4) Phillips screws removed from the OEM brackets, install the brackets with radio onto the OEM climate controls (NOTE: Align with locator tabs on TOYK978 brackets)
3. Using the main frame of the TOYK978 as a guide, slide radio forward or backward for desired look and then tighten screws to the radio.
4. Install brackets to rear of main frame using the (6) screws provided.

Note: If there is an OEM A/C module present you can install it to the NDK738 brackets using the OEM screws.

Fig. B

