

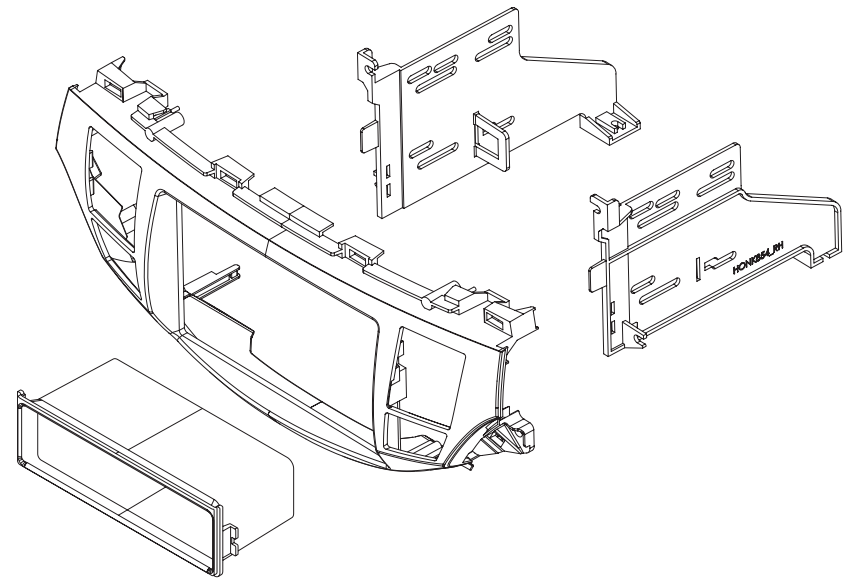

**American
International**
Car Stereo Installation Kits & Accessories



HONK854D / HONK854L Mounting Kit



www.aampglobal.com www.iaus.net
2500 East Francis Street Ontario, CA 91761, U.S.A.
Sales: (800) 477-2267
Intl: (727) 572-9255
Support: 888-228-5560

VEHICLE APPLICATION

Honda
2008-12 ACCORD (with OEM Navigation)
2010-12 CROSSTOUR (with OEM Navigation)

DASH DISASSEMBLY INSTRUCTIONS

1. Using a soft tool unsnap and remove the panel located in the center dash left of the radio.
2. Using a soft tool unsnap and remove the panel located in the right side of the dash above the glove box.
3. From the area now exposed, Remove (2) Phillips screws from the radio.
4. Using a soft tool unsnap and remove the air vents located in the center dash above the radio
5. Using a soft tool unsnap and remove the panel located in the console that includes the cup holders.
6. From the area now exposed, Remove (2) Phillips screws from the lower center dash. Remove (2) Phillips screws from the top of the pocket. Remove OEM pocket.
7. Remove (2) Phillips screws from the OEM navigation disc drive. Remove
8. From the area now exposed, Remove (2) Phillips screws facing up from the bottom of the OEM radio.
9. Using a soft tool unsnap and remove the radio with climate control panel. Unplug all harnesses ,along with the radio and antenna connections

MAIN FRAME PREPARATION

1. Unscrew (4) Phillips screws from both climate control button assembly and then remove from the OEM radio panel
2. Reinstall the climate control button assemblies to the HONK854 mainframe using (6) of the screws left over the disassembly, Do not screw the bottom inside location of each climate control, as they will be used later during the radio bracket installation.
3. Remove (2) plastic clips from the OEM radio and reinstall to the lower posts on the HONK854 mainframe.

KIT ASSEMBLY INSTRUCTIONS

Single ISO Mount Application

1. Insert pocket into lower section of the HONK854 brackets
2. Install brackets to rear of main frame using the (4) screws provided.
3. Insert ISO mountable radio between ISO mount brackets and loosely attach to sides of radio using screws provided with radio when possible, or screws supplied with kit.
4. Using the main frame of the HONK854 as a guide, slide radio forward or backward for desired look and then tighten screws to the radio.

NOTE: Using the screws removed from the bottom of the OEM radio brackets securely mount the HONK854 brackets to the sub-dash. Suggested.

Figure A

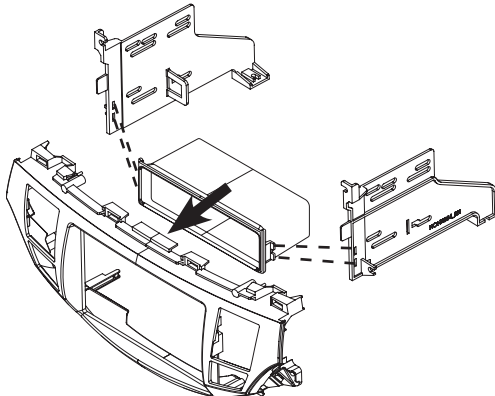

DOUBLE DIN INSTALLATION INSTRUCTIONS

Double DIN ISO Mount Application

See Fig B for bracket tab removal.

1. Remove pocket support tabs of the HONK854 brackets
2. Install brackets to rear of main frame using the (4) screws provided.
3. Insert ISO mountable radio between ISO mount brackets and loosely attach to sides of radio using screws provided with radio when possible, or screws supplied with kit.
4. Using the main frame of the HONK854 as a guide, slide radio forward or backward for desired look and then tighten screws to the radio.

NOTE: Using the screws removed from the bottom of the OEM radio brackets securely mount the HONK854 brackets to the sub-dash. Suggested.

Figure B

