

For information about other American International automotive accessories visit our website at:

<http://www.aius.net>

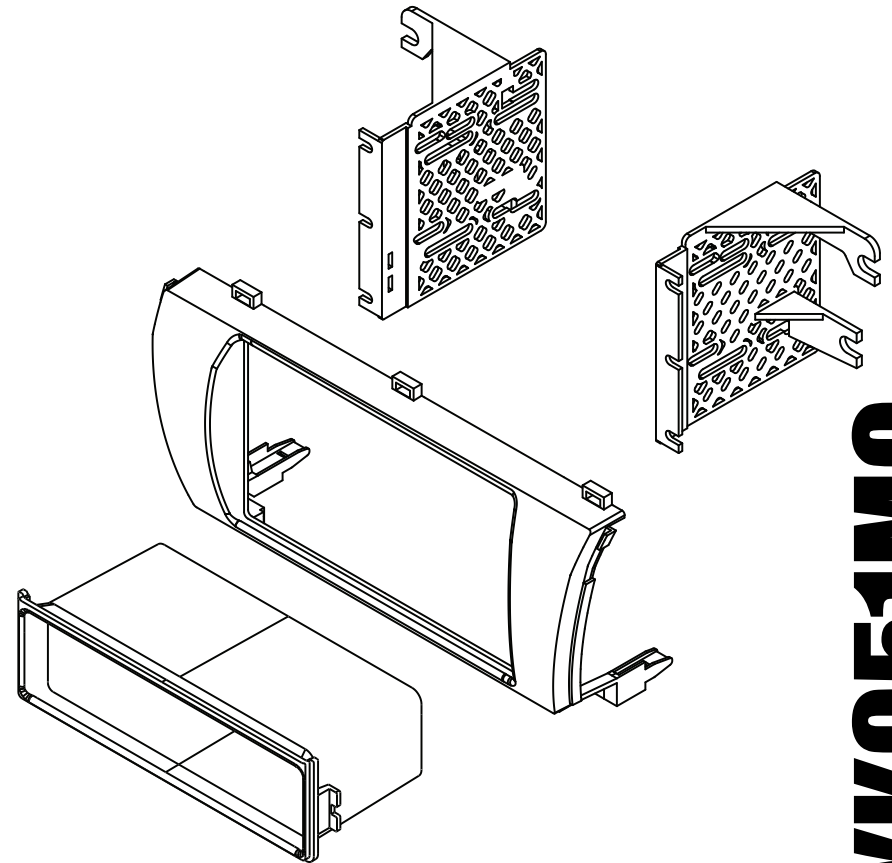

**American
International**
Car Stereo Installation Kits & Accessories



TOYK951MG Mounting Kit



American International

WWW.AIUS.NET

2500 East Francis Street Ontario, CA 91761, U.S.A.

USA Sales (800) 336-6500

Canada Sales (888) 922-3006

VEHICLE APPLICATIONS

Toyota
2014-15 COROLLA

CUSTOMER HELP LINE
USA 800-323-4329 • Canada 800-245-8777 iTOYK951MG

DASH DISASSEMBLY AND RADIO REMOVAL

1. Using a soft tool, carefully unclip and remove the top dash trim that surrounds the clock from the right to the left.
2. Using a soft tool, carefully unclip and remove the trim around the factory radio that includes the hazard button and airbag light display.
3. Unplug the hazard button, move panel aside. Do not unplug airbag light.
4. Remove (4) 10mm bolts from the bottom and top of the OEM Radio brackets.
5. Loosen the OEM radio and unplug all harness. Remove.
6. Remove (2) OEM plastic retainer clips from the OEM radio and save for the kit assembly.

KIT ASSEMBLY INSTRUCTIONS

Single ISO Mount Applications

1. Reinstall the (2) OEM plastic retainer clips onto the TOYK951MG posts.
2. Insert pocket into lower section of the mounting brackets, snap into slots.
3. Install brackets to rear of main frame using the (6) screws provided.
(Do Not Over tighten).
4. Insert ISO mountable radio between ISO mount brackets and loosely attach to sides of radio using screws provided with radio when possible or screws supplied with kit.
5. Slide radio forward or backward for desired look and tighten screws.
6. Attach a rear support bracket to the rear of the new radio and adjust as necessary to support the weight of the radio (optional).

FIG.A

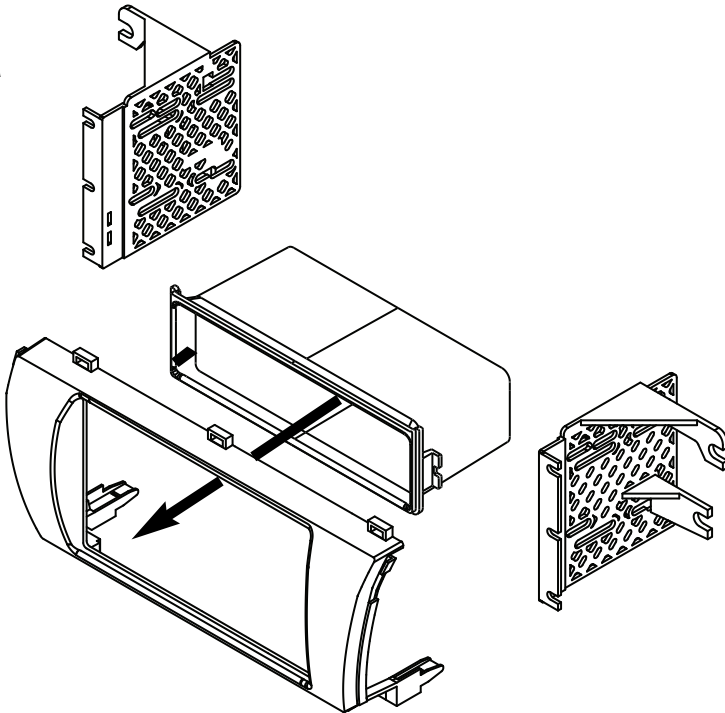

Double DIN Mount Applications

1. Reinstall the (2) OEM plastic retainer clips onto the TOYK951MG posts.
2. Install brackets to rear of main frame using the (6) screws provided.
(Do Not Over tighten).
3. Insert ISO mountable radio between ISO mount brackets and loosely attach to sides of radio using screws provided with radio when possible or screws supplied with kit.
4. Slide radio forward or backward for desired look and tighten screws.
5. Attach a rear support bracket to the rear of the new radio and adjust as necessary to support the weight of the radio (optional).

FIG.B

