

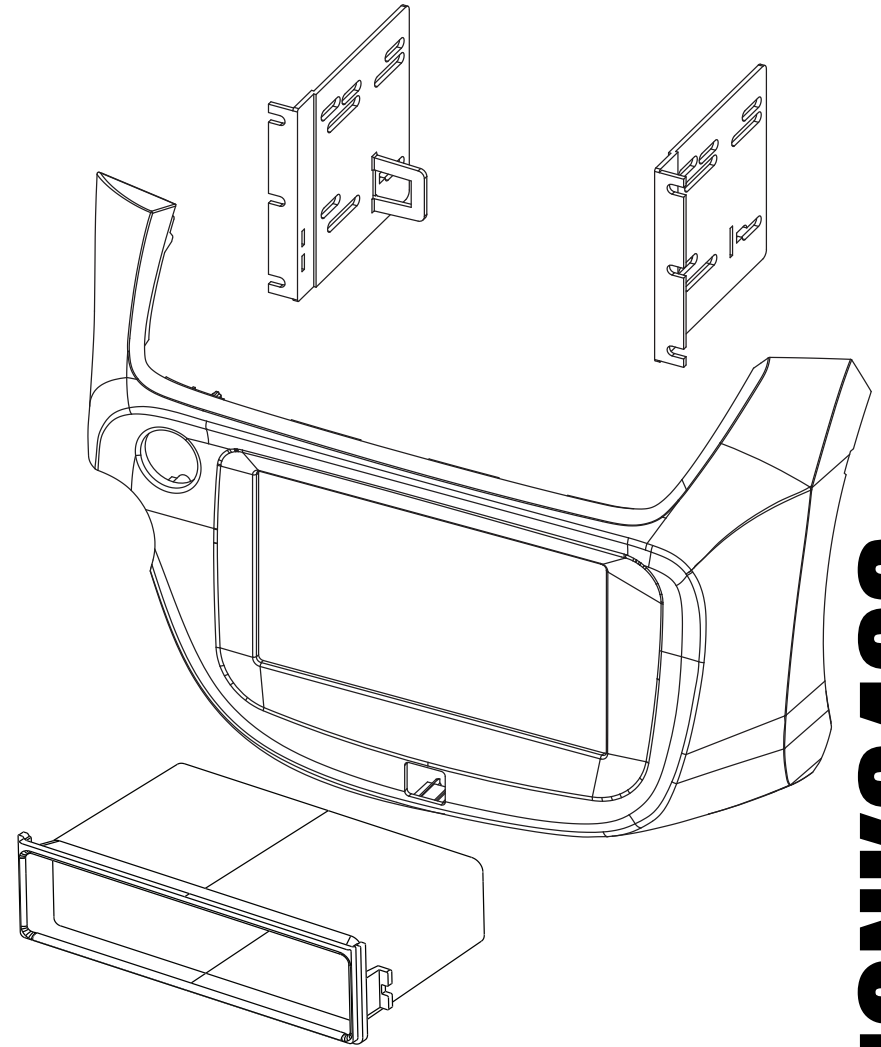

**American  
International**  
Car Stereo Installation Kits & Accessories



**HONK848S** Mounting Kit



**American International**

**WWW.AIUS.NET**

2500 East Francis Street Ontario, CA 91761, U.S.A.  
USA Sales (800) 336-6500

**CUSTOMER HELP LINE**  
USA 800-323-4329

iHONK848S

### VEHICLE APPLICATIONS

**Honda**  
2009-13 FIT

## DASH DISASSEMBLY INSTRUCTIONS

1. Using a soft tool unsnap and remove the panel located in the center dash below the radio.
2. From above the the area now exposed, Remove (1) 8mm bolt from the radio bracket. Bolt is facing up.
3. Open the upper glove box and using a soft tool unsnap and remove the radio with air vents panel.
4. Unplug all harnesses including the hazard and airbag light, along with the radio and antenna connections.

## HONK848S MAIN FRAME PREPARATION

1. Remove (2) Phillips Head screws from the hazard switch and reinstall to the HONK848S mainframe
2. Remove (2) Phillips Head screws from the air bag light and reinstall to the HONK848S mainframe
3. Remove (5) Phillips Head screws from the air vents and reinstall to the HONK848S mainframe.
4. Remove (7) plastic clips from the OEM radio and reinstall to the HONK848S mainframe.

## KIT ASSEMBLY INSTRUCTIONS

### Single ISO Mount Applications

1. Insert pocket into lower section of the HONK848S brackets
2. Install brackets to rear of main frame using the (6) screws provided.
3. Insert ISO mountable radio between ISO mount brackets and loosely attach to sides of radio using screws provided with radio when possible, or screws supplied with kit.
4. Using the main frame of the HONK848S as a guide, slide radio forward or backward for desired look and then tighten screws to the radio.

**NOTE:** Attach a rear support bracket to the rear of the new radio and adjust as necessary to support the weight of the radio. Suggested.

Fig A

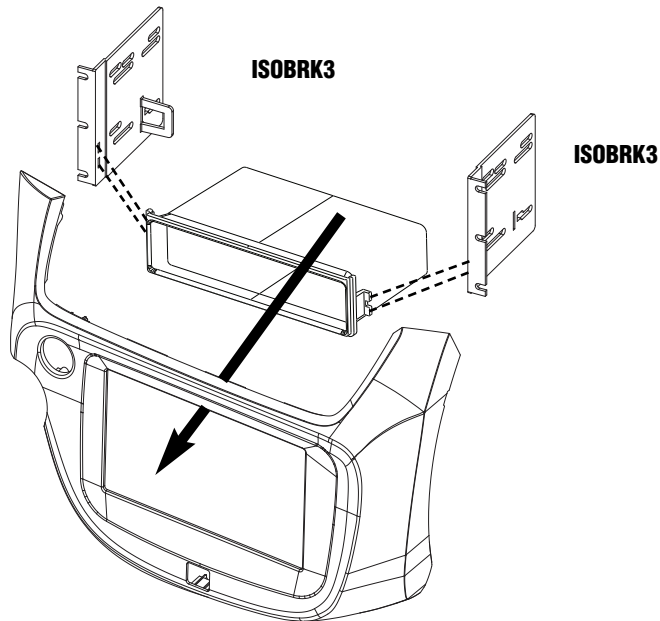

## DOUBLE DIN INSTALLATION INSTRUCTIONS

### Double DIN Mount Applications

**See Fig B for bracket tab removal.**

1. Install brackets to rear of main frame using the (6) screws provided.
2. Insert ISO mountable radio between ISO mount brackets and loosely attach to sides of radio using screws provided with radio when possible, or screws supplied with kit.
3. Using the main frame of the HONK848S as a guide, slide radio forward or backward for desired look and then tighten screws to the radio.

**NOTE:** Attach a rear support bracket to the rear of the new radio and adjust as necessary to support the weight of the radio. Suggested.

Fig B

