

DASH DISASSEMBLY INSTRUCTIONS

1. Unsnap plastic trim ring.
2. Remove (4) screws securing storage box or factory cassette player. Remove box and save screws.
3. Unsnap factory dash panel surrounding factory radio, heater, A/C, etc.
4. Remove (4) screws securing factory radio. Save screws.
5. Remove factory radio.

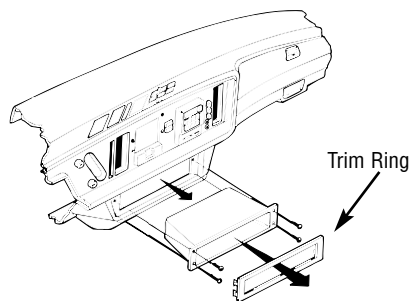

**END THE GUESSWORK...
USE A GWH-344 WIRING
HARNESS TO MAKE YOUR
INSTALLATION EVEN EASIER!**

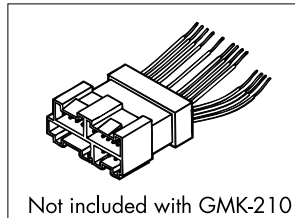

Note: Factory amplifier, wiring, and antenna lead are located under glove box. Antenna adapter GM-6 required as well as 48" antenna extension and all wiring must be extended to new radio location.

KIT ASSEMBLY INSTRUCTIONS

1. Install storage box using (4) screws that secured factory radio.
2. Install GMK-210 using (4) screws that secured factory storage box.
3. Snap in screw covers.

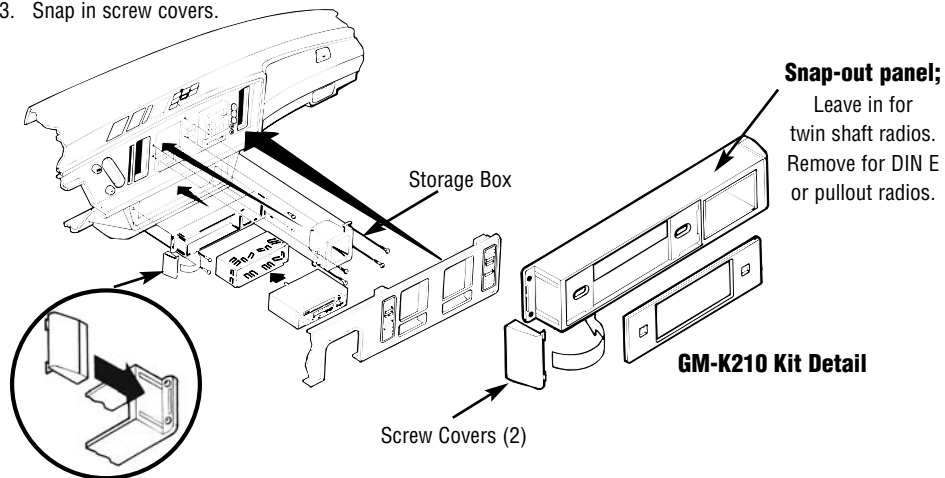

American International

Automotive Products Division

1040 Avenida Acaso • Camarillo, CA 93012, U.S.A.

USA Sales (800) 336-6500

Canada Sales (888) 922-3006 • USA Fax (805) 388-7950

CUSTOMER HELP LINE

USA 800-323-4329 • Canada 800-245-8777



American International

Car Stereo Installation Kits & Accessories



GM-K210 Mounting Kit

VEHICLE APPLICATIONS

Buick
1988-94 REGAL