

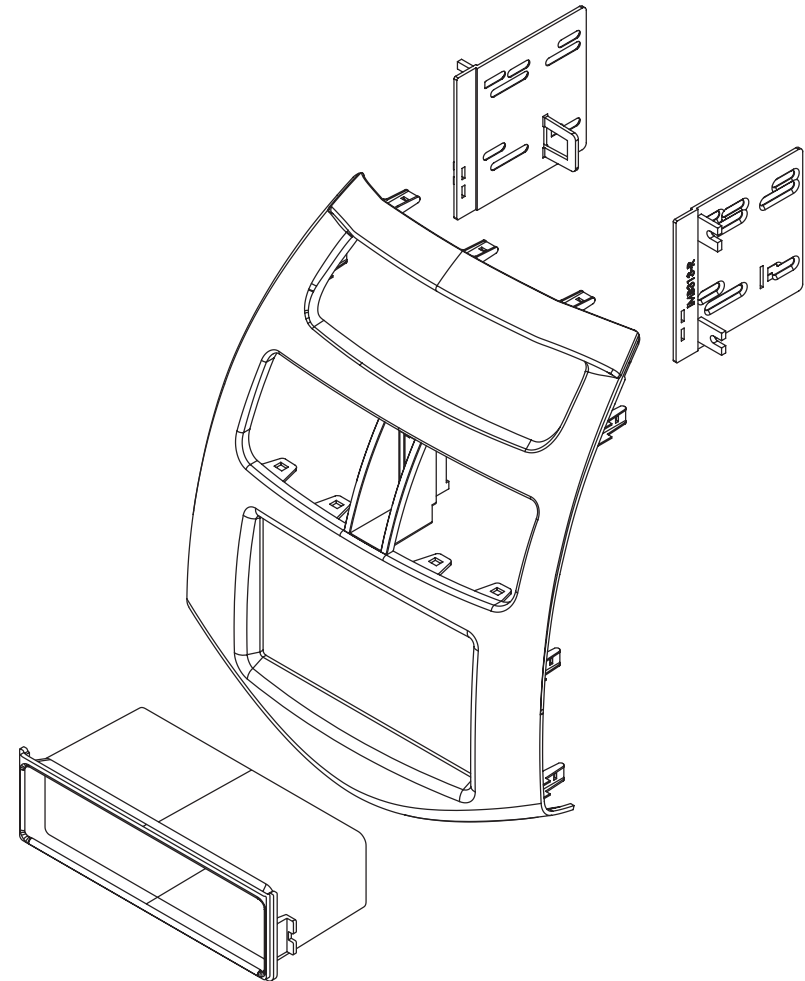

**American  
International**  
Car Stereo Installation Kits & Accessories



# GMK313 Mounting Kit



[www.aampglobal.com](http://www.aampglobal.com) [www.aius.net](http://www.aius.net)

2500 East Francis Street Ontario, CA 91761, U.S.A.

Sales: (800) 477-2267

Intl: (727) 572-9255

Support: 888-228-5560

## VEHICLE APPLICATION

**Chevrolet**

2013-16 SPARK

### Sub-Dash Note

The Spark sub-dash can have metal or plastic that will prevent the radio to be centered in the panel opening. You may need to trim/modify the sub-dash to center the radio.

## DASH DISASSEMBLY INSTRUCTIONS

1. Using a soft tool unsnap and remove the panel located in the center dash surrounding of the radio, that includes the air vents.
2. From the OEM radio, Remove (4) Phillips screws. Remove.
3. Unplug all harnesses including the hazard button, along with the radio and antenna connections.

## MAIN FRAME PREPARATION

1. Remove the hazard switch and reinstall to the GMK313 mainframe
2. Remove the air vents from the OEM panel and reinstall to the GMK313 mainframe.
3. Remove (5) Phillips Head screws from the top OEM shroud, and reinstall to the GMK313 mainframe.

## KIT ASSEMBLY INSTRUCTIONS

### Single ISO Mount Application

**Note:** DO NOT snap metal clips to mainframe until you are at step 6.

1. Insert pocket into lower section of the GMK313 brackets.
2. Insert ISO mountable radio between ISO mount brackets and loosely attach to sides of radio using screws provided with radio when possible, or screws supplied with kit.
3. Slide radio forward or backward for desired look and tighten screws.
4. Install radio and brackets into sub-dash
5. Test fit the main frame of the GMK313 into the dash (without the clips installed) and make sure it aligns correctly with the pocket and does not leave any gaps, and the radio looks good. If everything looks correct go to step #6. If not, go back to step # 3.
6. Attach the (11) metal clips supplied to the mainframe  
Snap mainframe to the dash by pressing firmly

Figure A

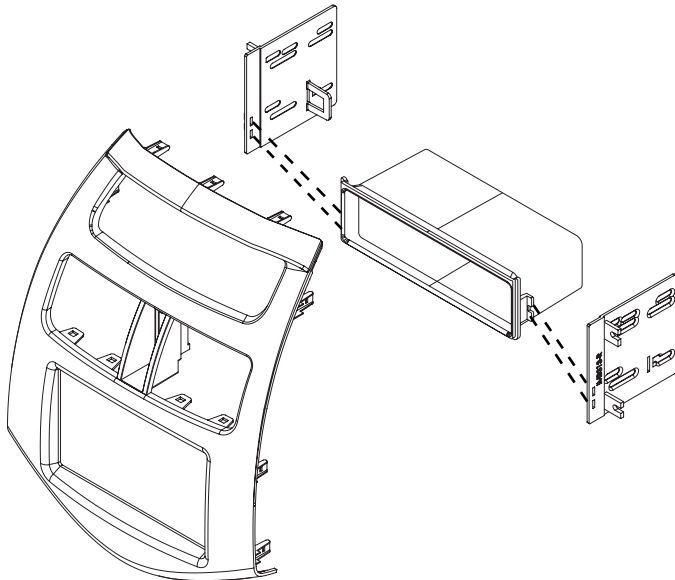

## DOUBLE DIN INSTALLATION INSTRUCTIONS

### Double DIN ISO Mount Application

**Note:** DO NOT snap metal clips to mainframe until you are at step 6.

1. Remove pocket support tabs from the GMK313 brackets.
2. Insert ISO mountable radio between ISO mount brackets and loosely attach to sides of radio using screws provided with radio when possible, or screws supplied with kit.
3. Slide radio forward or backward for desired look and tighten screws.
4. Install radio and brackets into sub-dash
5. Test fit the main frame of the GMK313 into the dash (without the clips installed) and make sure it aligns correctly and does not leave any gaps, and the radio looks good. If everything looks correct go to step #6. If not, go back to step # 3.
6. Attach the (11) metal clips supplied to the mainframe  
Snap mainframe to the dash by pressing firmly

Figure B

