

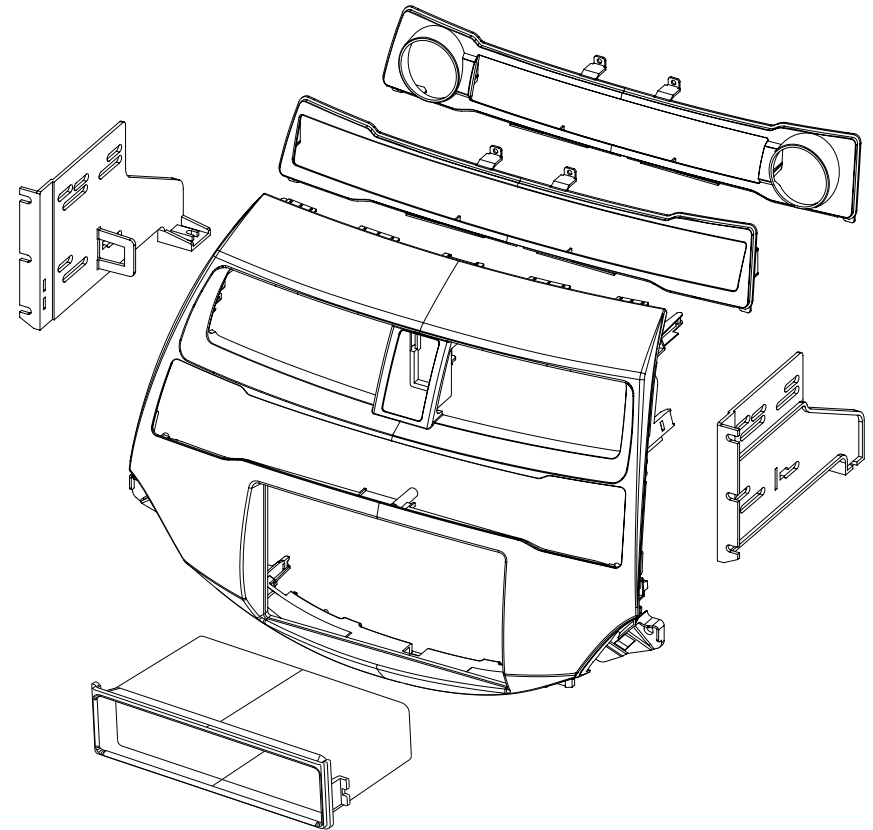

**American
International**
Car Stereo Installation Kits & Accessories



HONK852D HONK852L Mounting Kit



www.aampglobal.com www.aius.net

2500 East Francis Street Ontario, CA 91761, U.S.A.

Sales: (800) 477-2267

Intl: (727) 572-9255

Support: 888-228-5560

VEHICLE APPLICATION

Honda

2008-12 ACCORD (without OEM Navigation)

2010-12 CROSSTOUR (without OEM Navigation)

iHONK852D/
iHONK852L

©2016 AMERICAN INTERNATIONAL INDUSTRIES, INC.

TECH Ver. 3/16 PRINT Ver. 6/16

DASH DISASSEMBLY INSTRUCTIONS

1. Using a soft tool unsnap and remove the panel located in the center dash left of the radio.
2. Using a soft tool unsnap and remove the panel located in the right side of the dash above the glove box.
3. From the area now exposed, Remove (2) Phillips screws from the radio.
4. Using a soft tool unsnap and remove the panel located in the console that includes the cup holders.
5. From the area now exposed, Remove (2) Phillips screws from the lower center dash. Remove OEM pocket.
6. From the area now exposed, Remove (2) Phillips screws facing up from the bottom of the OEM radio.
7. Using a soft tool unsnap and remove the radio with air vents panel.
8. Unplug all harnesses including the hazard/airbag light, along with the radio and antenna connections.

MAIN FRAME PREPARATION

1. Choose the climate control adapter that works with either auto or manual climate control, and using the (4) screws supplied install onto the HONK852 mainframe.
2. Remove the hazard/airbag light switch and reinstall to the HONK852 mainframe.
3. Remove (6) Phillips Head screws from the OEM climate controls, Remove (4) Phillips Head screws from the air vents and reinstall both parts to the HONK852 mainframe.
4. Remove (4) Phillips Head screws from the lower radio trim and reinstall to the HONK852 mainframe.
5. Remove (9) plastic clips from the OEM radio and reinstall to the HONK852 mainframe.

KIT ASSEMBLY INSTRUCTIONS

Single ISO Mount Application

1. Insert pocket into lower section of the HONK852 brackets
 2. Install brackets to rear of main frame using the (6) screws provided.
 3. Insert ISO mountable radio between ISO mount brackets and loosely attach to sides of radio using screws provided with radio when possible, or screws supplied with kit.
 4. Using the main frame of the HONK852 as a guide, slide radio forward or backward for desired look and then tighten screws to the radio.
- NOTE:** Using the screws removed from the bottom of the OEM radio brackets securely mount the HONK852 brackets to the sub-dash. Suggested.

Figure A

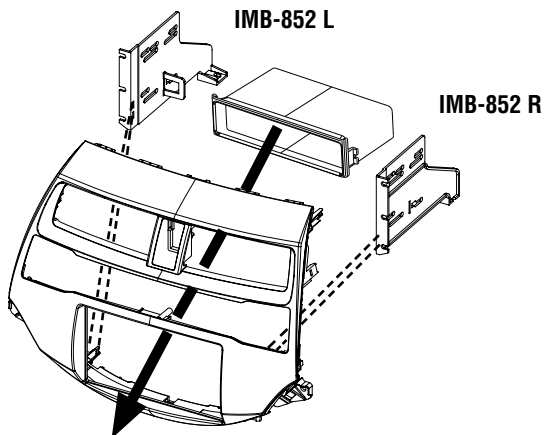

DOUBLE DIN INSTALLATION INSTRUCTIONS

Double DIN ISO Mount Application

See figure B for Bracket Tab Removal

1. Install brackets to rear of main frame using the (6) screws provided.
 2. Insert ISO mountable radio between ISO mount brackets and loosely attach to sides of radio using screws provided with radio when possible, or screws supplied with kit.
 3. Using the main frame of the HONK852 as a guide, slide radio forward or backward for desired look and then tighten screws to the radio.
- NOTE:** Using the screws removed from the bottom of the OEM radio brackets securely mount the HONK852 brackets to the sub-dash. Suggested.

Figure A

