

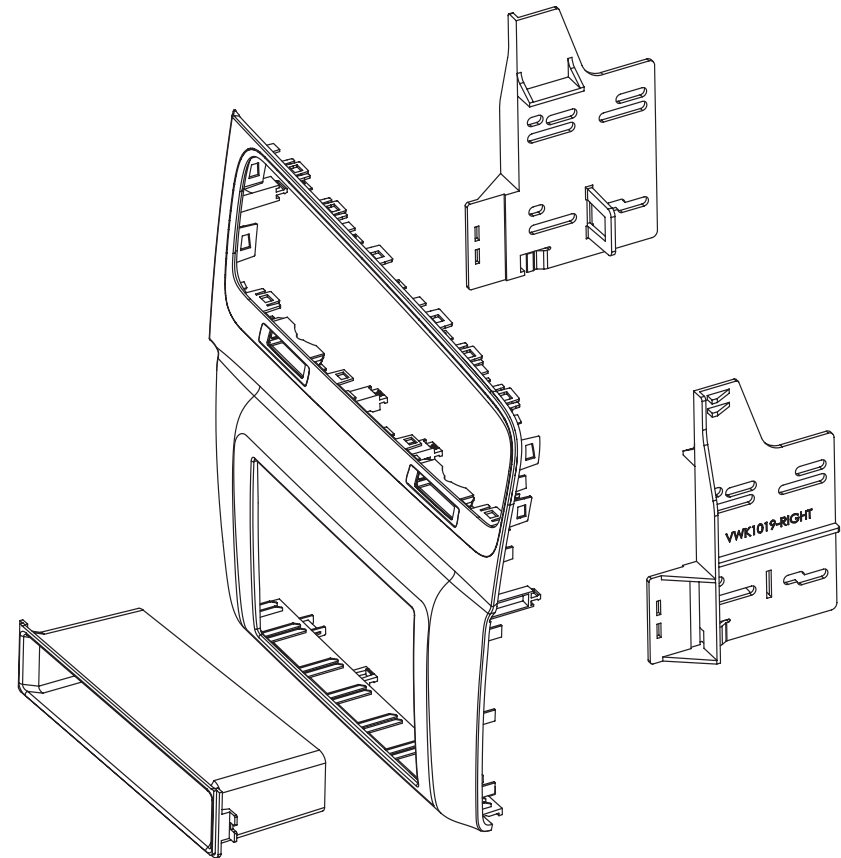

**American
International**
Car Stereo Installation Kits & Accessories



VWK1019 Mounting Kit



www.bestkits.com www.aampglobal.com www.aius.net

2500 East Francis Street Ontario, CA 91761, U.S.A.

Sales: (800) 477-2267

Intl: (727) 572-9255

Support: 888-228-5560

VEHICLE APPLICATION

Volkswagen

2015-16 GOLF

**NOTE: THIS INSTALLATION KIT REQUIRES PROFESSIONAL INSTALLATION.
MAJOR SUB-DASH MODIFICATION IS REQUIRED TO FIT RADIO.**

DASH DISASSEMBLY INSTRUCTIONS

1. Using a soft tool unsnap climate control trim panel.
2. Unsnap and remove hazard button/airbag light. Unplug.
3. Using a soft tool Gently unsnap and remove dash trim bezel, that includes the air vents and surrounds the radio.
4. Using European radio removal tools, remove the OEM screen. Unplug.
5. Remove air vents including chrome trim from OEM dash panel, save for kit assembly.

Note: To aid removal of dash bezel, hold the dash thru the hazard opening and pull.

NOTE: THIS INSTALLATION KIT REQUIRES PROFESSIONAL INSTALLATION. MAJOR SUB-DASH MODIFICATION IS REQUIRED TO FIT RADIO.

KIT ASSEMBLY INSTRUCTIONS

Single ISO Mount Application

1. Snap the factory chrome trim into the VWK1019
 2. Install the vent into the VWK1019
 3. Insert pocket into lower section of the brackets and snap into rear pocket support tabs.
 4. Insert ISO mountable radio between ISO mount brackets and loosely attach to sides of radio using screws provided with radio when possible, or screws supplied with kit. Using the main frame of the VWK1019 as a guide, slide radio forward or backward for desired look and then tighten screws to the radio
- Note:** To remove radio and brackets after they have been snapped into dash, use a flat head screwdriver on the bottom outside of the VWK1019 brackets to release the snaps

Figure A

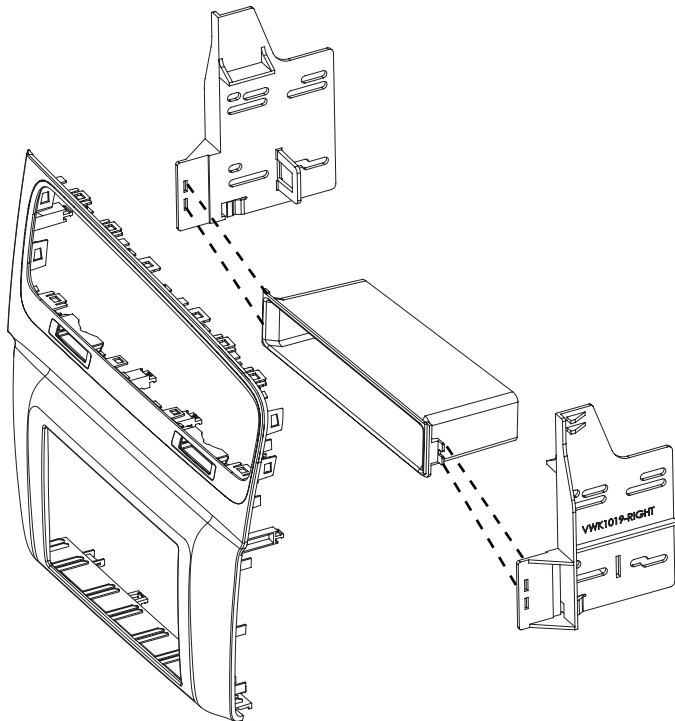

DOUBLE DIN INSTALLATION INSTRUCTIONS

Double DIN ISO Mount Applications

1. Snap the factory chrome trim into the VWK1019
2. Install the vent into the VWK1019
3. Insert ISO mountable radio between ISO mount brackets and loosely attach to sides of radio using screws provided with radio when possible, or screws supplied with kit. Using the main frame of the VWK1019 as a guide, slide radio forward or backward for desired look and then tighten screws to the radio

Note: To remove radio and brackets after they have been snapped into dash, use a flat head screwdriver on the bottom outside of the VWK1019 brackets to release the snaps

Figure B

