

**IN-DASH STEREO INSTALLATION KIT FOR
2006-UP MAZDA 5 VEHICLES**

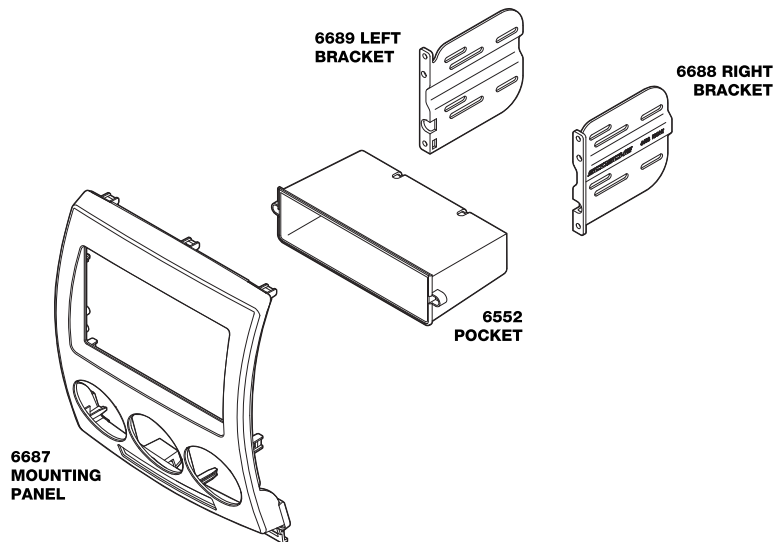

INTRODUCTION/PRELIMINARY

This premium installation kit is for 2006-Up Mazda 5 vehicles. Included are all the parts you need to mount your car stereo or CD player into your vehicle's dash. Refer to the individual instruction in this manual to remove your vehicle's factory radio and assemble the kit.

CAUTION
DISCONNECT YOUR VEHICLE'S NEGATIVE BATTERY TERMINAL BEFORE THE INSTALLATION TO HELP PREVENT ELECTRICAL DAMAGE. WE RECOMMEND THE USE OF A VOLT/OHM METER OVER A TEST LIGHT TO CHECK WIRING. A TEST LIGHT OR GROUNDED WIRE PROBE CAN CAUSE DAMAGE TO THE VEHICLE'S COMPUTER AND/OR DIAGNOSTIC SYSTEMS. AVOID ALL FACTORY AIRBAG WIRING - AIRBAGS CAN ACCIDENTALLY DEPLOY CAUSING SERIOUS INJURY OR DEATH.

- NOTES**
- See your vehicle's instructions for any special tools your installation might require.
 - Read all instructions accompanying your car stereo for proper wiring and mounting instructions.

FACTORY WIRING CODES

For Factory Wiring Codes go to: www.scosche-cars.com

CAR STEREO CONNECTORS

PROVIDE EASY CONNECTION OF YOUR CAR STEREO TO FACTORY WIRING HARNESS.

MA03B

2000-Up select Mazda speaker connector

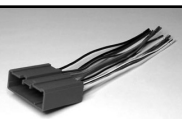

LIABILITY DISCLAIMER

This instruction booklet is based on carefully documented data and research of automobile dash disassembly, wire harness/codes and information pertaining to installation of this kit (MA1538B) in 2006-Up Mazda 5 vehicles. Scosche Industries, Inc. cannot be held responsible for discrepancies/inconsistencies that may occur due to the automobile manufacturing changes or options, or damage that may occur in the automobile during the installation of components while using this booklet.

If you have any further questions, call our toll free technical help line at: **1-800-621-3695x3**

FACTORY STEREO REMOVAL

2006-07 MAZDA 5

1. Using a panel removal tool (PRT) unclip and remove lower panels of center dash.
2. Extract (1) Phillips head screw from each side (right & left) of center dash.
3. Unscrew shifter knob.
4. Using a PRT unclip and remove panel below shifter.
5. Extract (2) Phillips head screws from under shifter panel.
6. Pull lower center dash toward you to unclip.
7. Extract (2) Phillips screws from stereo panel.
8. Pull radio panel toward you to unclip. Disconnect stereo and remove.

2008-UP MAZDA 5

1. Unscrew shifter knob.
2. Using a panel removal tool (PRT) remove cup holder panel.
3. Using a PRT unclip power outlet panel and unclip shifter panel.
4. Extract (2) 8mm screws from front of center console.
5. Use pick tool to remove to remove (2) screw covers from rear of center console.
6. Extract (2) Phillips head screws from behind.
7. Unclip rear panel of center console. Lift center console and pull away from the dash.
8. Use pick tool to remove to remove (2) screw covers from sides of center stack.
9. Extract (2) Phillips head screws from behind.
10. Unclip side panels from center stack (at footwell)
11. Extract (2) Phillips head screws from behind.
12. Extract (2) Phillips head screws from front of center stack.
13. Unclip lower center stack panel by pulling toward you.
14. Extract (2) Phillips head screws from bottom of stereo panel.
15. Unclip stereo panel. Unplug and remove stereo.

MOUNTING THE STEREO

SINGLE DIN MOUNT

1. Attach the 6552 pocket to 6687 panel using (2) screws supplied.
2. Attach the 6688 and 6689 brackets to 6687 panel using (4) screws supplied.
3. Align and screw aftermarket stereo to 6688 and 6689 brackets using screws supplied with aftermarket stereo.

Note: If hardware is not supplied with aftermarket stereo use hardware from factory stereo.

4. Reconnect stereo and snap panel, brackets and aftermarket stereo assembly into dash. Finish dash reassembly.

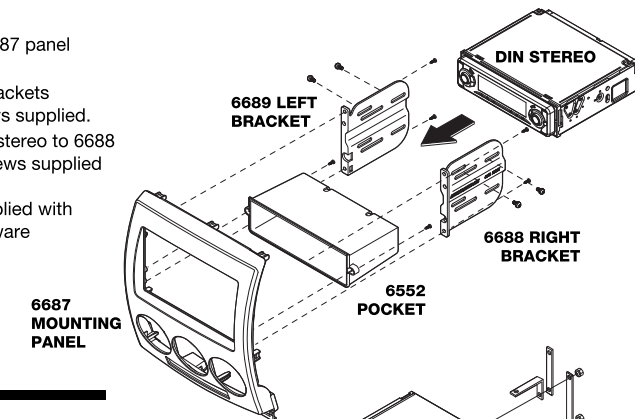

DOUBLE DIN MOUNT

1. Attach the 6688 and 6689 brackets to 6687 panel using (4) screws supplied.
2. Align and screw aftermarket double din stereo to 6688 and 6689 brackets using screws supplied with aftermarket stereo.

Note: If hardware is not supplied with aftermarket stereo use hardware from factory stereo.

4. Reconnect stereo and snap panel, brackets and aftermarket stereo assembly into dash. Finish dash reassembly.

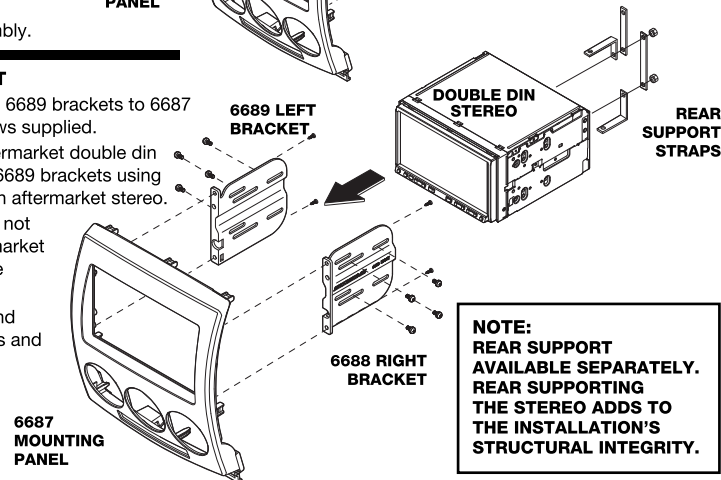

NOTE:
REAR SUPPORT AVAILABLE SEPARATELY. REAR SUPPORTING THE STEREO ADDS TO THE INSTALLATION'S STRUCTURAL INTEGRITY.