

IN-DASH DIN STEREO INSTALLATION KIT FOR 2006-UP MITSUBISHI ECLIPSE

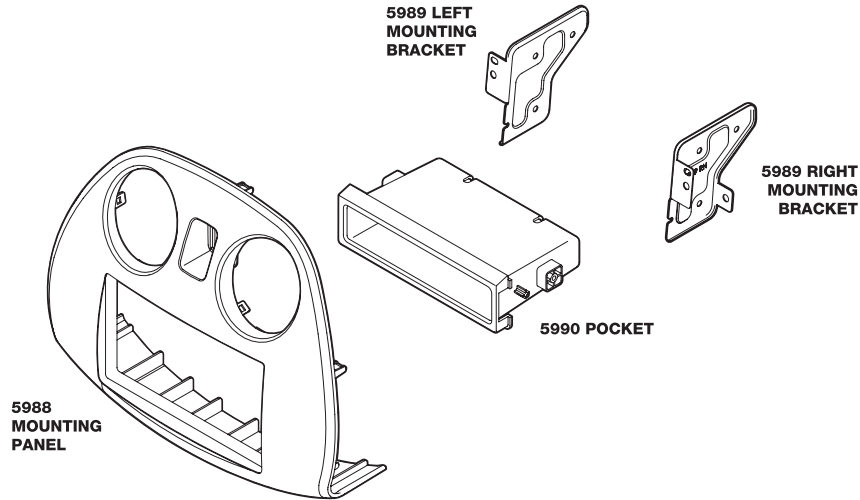

INTRODUCTION/PRELIMINARY

This premium installation kit is for 2006-UP Mitsubishi Eclipse vehicles. Included are all the parts you need to mount your car stereo or CD player into your vehicle's dash. Refer to the individual instruction in this manual to remove your vehicle's factory radio and assemble the kit.

CAUTION
DISCONNECT YOUR VEHICLE'S NEGATIVE BATTERY TERMINAL BEFORE THE INSTALLATION TO HELP PREVENT ELECTRICAL DAMAGE. WE RECOMMEND THE USE OF A VOLT/OHM METER OVER A TEST LIGHT TO CHECK WIRING. A TEST LIGHT OR GROUNDED WIRE PROBE CAN CAUSE DAMAGE TO THE VEHICLE'S COMPUTER AND/OR DIAGNOSTIC SYSTEMS. AVOID ALL FACTORY AIRBAG WIRING - AIRBAGS CAN ACCIDENTALLY DEPLOY CAUSING SERIOUS INJURY OR DEATH.

- NOTES**
- See your vehicle's instructions for any special tools your installation might require.
 - Read all instructions accompanying your car stereo for proper wiring and mounting instructions.

FACTORY WIRING CODES

For Factory Wiring Codes go to: www.scosche-cars.com

CAR STEREO CONNECTORS

PROVIDE EASY CONNECTION OF YOUR CAR STEREO TO FACTORY WIRING HARNESS.

MI02B
 2006-UP Mitsubishi Eclipse
 Standard System

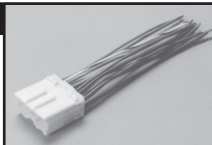

LIABILITY DISCLAIMER

This instruction booklet is based on carefully documented data and research of automobile dash disassembly, wire harness/codes and information pertaining to installation of this kit (MI3017B) in 2006-UP Mitsubishi Eclipse vehicles. Scosche Industries, Inc. cannot be held responsible for discrepancies/inconsistencies that may occur due to the automobile manufacturing changes or options, or damage that may occur in the automobile during the installation of components while using this booklet.

If you have any further questions, call our toll free technical help line at: **1-800-621-3695x3**

FACTORY STEREO REMOVAL

2006-UP MITSUBISHI ECLIPSE RADIO REMOVAL

1. Using a panel removal tool, pry off the radio bezel. Disconnect hazard switch and remove.
2. Remove (4) Phillips head screws from radio brackets. Disconnect and remove.
3. Using a PRT, remove the hazard switch, and vents from factory bezel.

MOUNTING THE STEREO

ATTACHING THE SINGLE DIN STEREO

1. Secure the 5990 pocket to the LEFT & RIGHT 5989 brackets with the (2) supplied screws.
2. Mount the aftermarket stereo to the mounting brackets with the stereo's supplied screws.

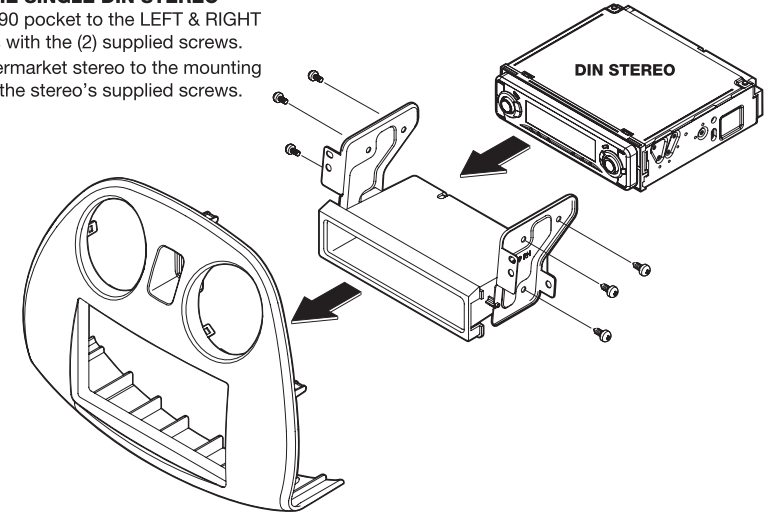

ATTACHING THE DOUBLE DIN STEREO

1. Align and position the aftermarket stereo to the LEFT & RIGHT 5989 mounting brackets.
2. Using the screws supplied with the aftermarket double din stereo secure the stereo to the mounting brackets.

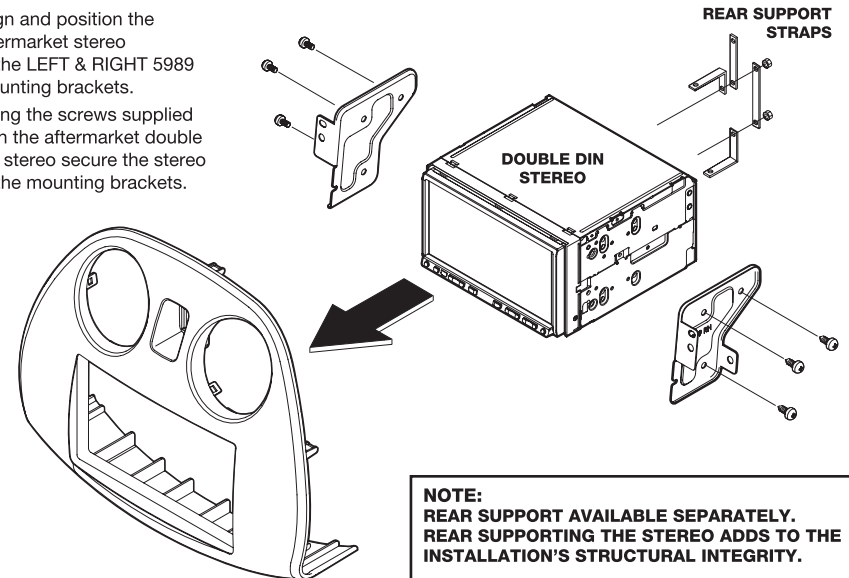

NOTE:
REAR SUPPORT AVAILABLE SEPARATELY. REAR SUPPORTING THE STEREO ADDS TO THE INSTALLATION'S STRUCTURAL INTEGRITY.